



Road Running Technical Council
USA Track & Field
Measurement Certificate



Name of the course Juneau Half-Marathon Distance 21.0975 km
Location (state) AK (city) Douglas
Type of course: Road Race
Measuring Methods: Bicycle
Measured By David Epstein, 10705 Horizon Drive, Juneau, AK 99801, dave1013@gmail.com, 907-209-7995
Race Contact David Epstein, 10705 Horizon Dr, Juneau, AK 99801, dave1013@gmail.com, (907) 209-7995
Date(s) when course measured: May 17, 2025
Number of measurements of entire course: 4 Course Configuration: Out and back
Elevation (meters above sea level) Start 26.00 Finish 26.00 Lowest 26.00 Highest 80.00
Straight line distance between start and finish 0m Drop 0.00 m/km Separation 0.00 %
Type of surface: Paved 100 % Dirt 0 % Gravel 0 % Grass 0 % Track 0 %
Effective date of certification: June 18, 2025 Certification code: AK25008FW

Note to Race Director: Use this Certification Code
in all public announcements relating to your race.

Be It Officially Noted That

Based on examination of data provided by the above named measurer, the course described above and in the map attached is hereby certified as reasonably accurate in measurement according to the standards adopted by the Road Running Technical Council. If any changes are made to the course, this certification becomes void, and the course must then be recertified.

Verification of Course --- In the event a National Open Record is set on the course, or at the discretion of USA Track & Field, a verification measurement may be required to be performed by a member of the Road Running Technical Council. If such a remeasurement shows the course to be short, then all pending records will be rejected and the course certification will be cancelled.

This certification expires on December 31 of the year: **2035**

AS NATIONALLY CERTIFIED BY:

Date: July 2, 2025

Frederic H Wilson - USATF/RRTC Certifier - 2420 Glenwood St., Anchorage AK 99508
(907) 980-2524 - ricalaska01@gmail.com



JUNEAU HALF-MARATHON - DOUGLAS, ALASKA

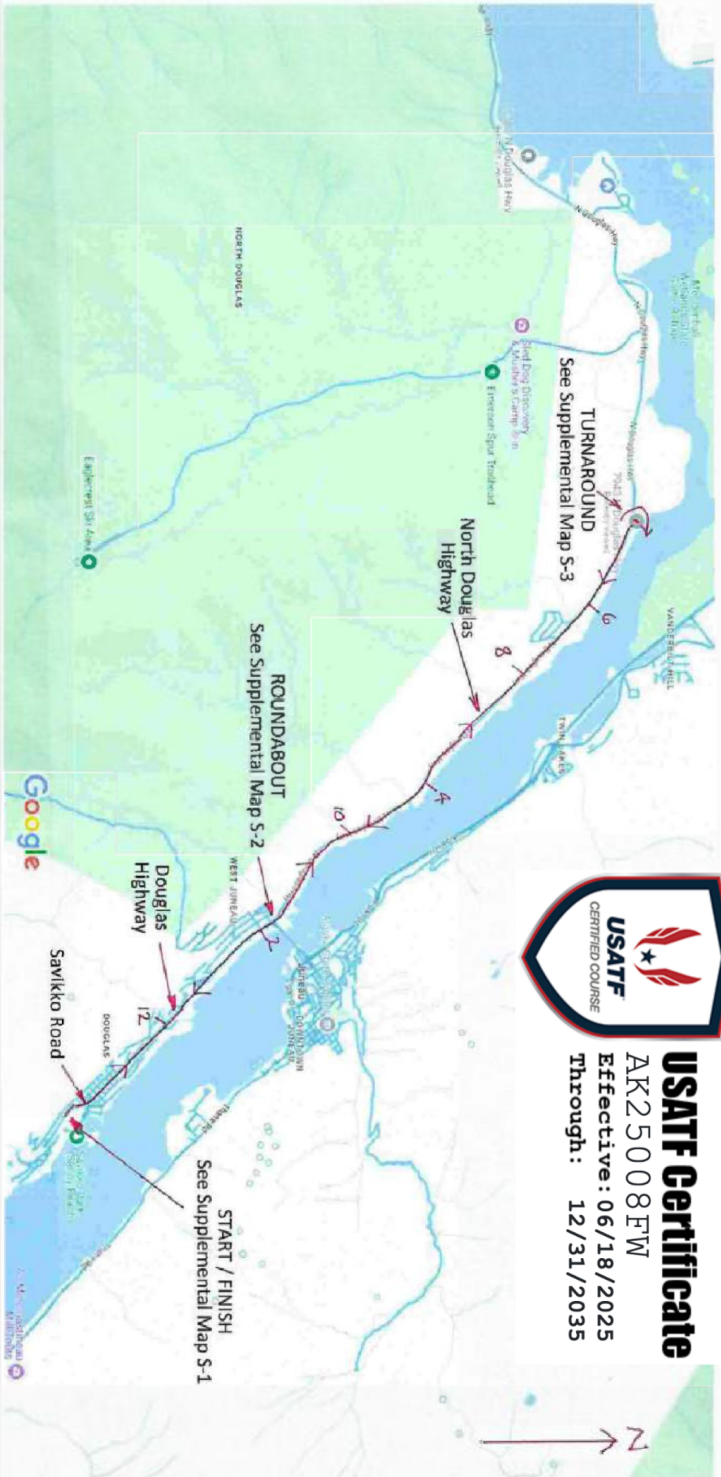

- **MEASURED BY** David Epstein (email dave1013@gmail.com) & Suzanne Sauerteig on May 17, 2025. Course length = 21.0975 km.
- **COURSE RESTRICTIONS:** The course is restricted to the upland shoulder / bike lane of Savikko Road, Douglas Highway, and North Douglas Highway. It maintains a one-foot buffer from the edge of pavement and the white "fog" line.
- **THIS COURSE WAS MEASURED USING THE FULL WIDTH OF THE UPLAND SHOULDER OF THE ROAD AND THE SHORTEST POSSIBLE ROUTE (SPR). CONES ARE PLACED AT EVERY MILE MARKER.**



SUPPLEMENTAL MAP PAGE S-1, INSET MAP FOR START/FINISH LINE DETAIL

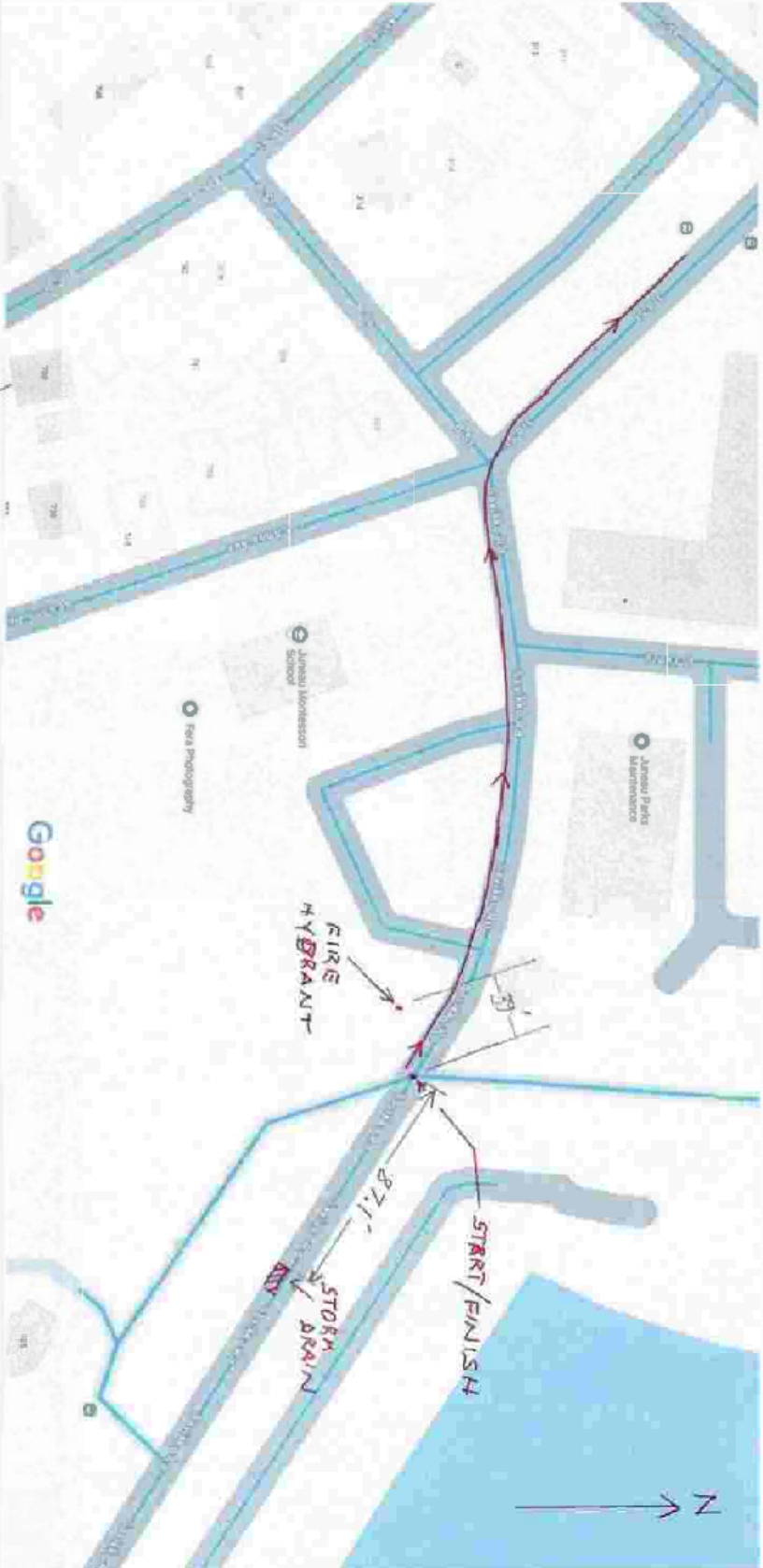

Course starts and finishes on the upland shoulder of Savikko Road at the third driveway down from the St. Anns / 3rd Street intersection. It is marked by a P-K nail in the pavement joint that is an extension of the adjacent concrete curb joint. It is 39 ft from a fire hydrant on the other side of the driveway and 87.1 ft from a storm drain located in the gutter pan to the southeast.



SUPPLEMENTAL MAP PAGE S-2, ROUNDABOUT DETAIL



Just prior to the roundabout, the course takes a slight left turn onto a gravel path at a point marked by a cone that is 30 ft west of the sign for bus stop #S17. The course follows the gravel path for 50 ft to a paved frontage street (Sitka Street) and proceeds to North Douglas Highway. Runners have use of the full width of Sitka Street. The course turns left onto the upland shoulder/bike lane of North Douglas Highway and proceeds to the turnaround point.



SUPPLEMENTAL MAP PAGE S-3, INSET MAP FOR TURNAROUND

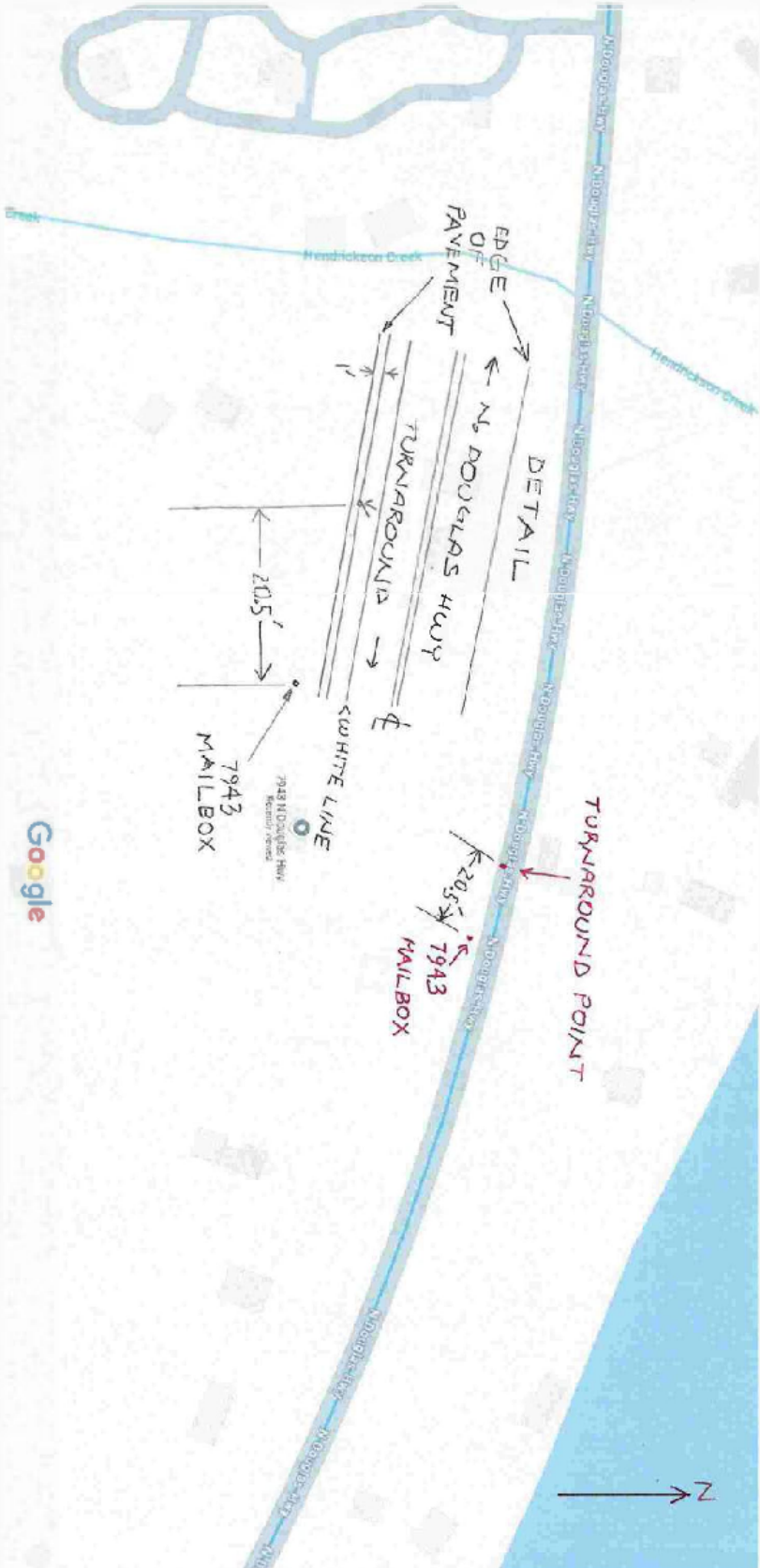

The half-marathon turnaround point is on the upland shoulder bike lane of North Douglas Highway. It is marked by a P-K nail, 1 ft off the edge of pavement on centerline extended of the driveway to residence 7943, and 20.5 ft northwest of the residence's mailbox. A cone will be placed on the shoulder at the turnaround point.