



**Road Running Technical Council  
USA Track & Field**

# **Measurement Certificate**



Name of the course Greater Binghamton Bridge Run Half Marathon 2023 Distance 21.0975 km  
 Location (state) NY (city) Binghamton  
 Type of course: Road Race  
 Measuring Methods: Bicycle  
 Measured By Diana Bean, 180 W. Lake Road, Brackney, PA 18812 607-240-9858 dbean0120@gmail.com  
 Race Contact Amy Shaw, 607-772-8860 ashaw@greaterbinghamtonchamber.com  
 Date(s) when course measured: 08/08/2022, 09/18/2022, 10/02/2022  
 Number of measurements of entire course: 2 Course Configuration: complex of different loops  
 Elevation (meters above sea level) Start 263.00 Finish 262.00 Lowest 251.00 Highest 279.00  
 Straight line distance between start and finish 36m Drop 0.05 m/km Separation 0.17 %  
 Type of surface: Paved 100 % Dirt 0 % Gravel 0 % Grass 0 % Track 0 %  
 Effective date of certification: January 1, 2023 Certification code: NY23002DNB

Note to Race Director: Use this Certification Code in all public announcements relating to your race.

## ***Be It Officially Noted That***

Based on examination of data provided by the above named measurer, the course described above and in the map attached is hereby certified as reasonably accurate in measurement according to the standards adopted by the Road Running Technical Council. If any changes are made to the course, this certification becomes void, and the course must then be recertified.

**Verification of Course ---** In the event a National Open Record is set on the course, or at the discretion of USA Track & Field, a verification measurement may be required to be performed by a member of the Road Running Technical Council. If such a remeasurement shows the course to be short, then all pending records will be rejected and the course certification will be cancelled.

***This certification expires on December 31 of the year:*** **2033**

**AS NATIONALLY CERTIFIED BY:**

Date: January 5, 2023

Diana Bean - USATF/RRTC Certifier - 180 W. Lake Road, Brackney PA 18812  
 (607) 240-9858 - dbean0120@gmail.com

# Greater Binghamton Bridge Run Half Marathon 2023

Binghamton, NY / 21.0975 km

- Course is run as shown.
- Course was measured using the full width of the road and the shortest possible route with two exceptions: 1. On Clinton St., runners stay to right going under RR overpass. 2. On Main St., runners stay to the right of the double yellow line, running with traffic.
- See second page for mile splits.



**USATF Certificate**  
 NY23002DNB  
 Effective: 01/01/2023  
 Through: 12/31/2033

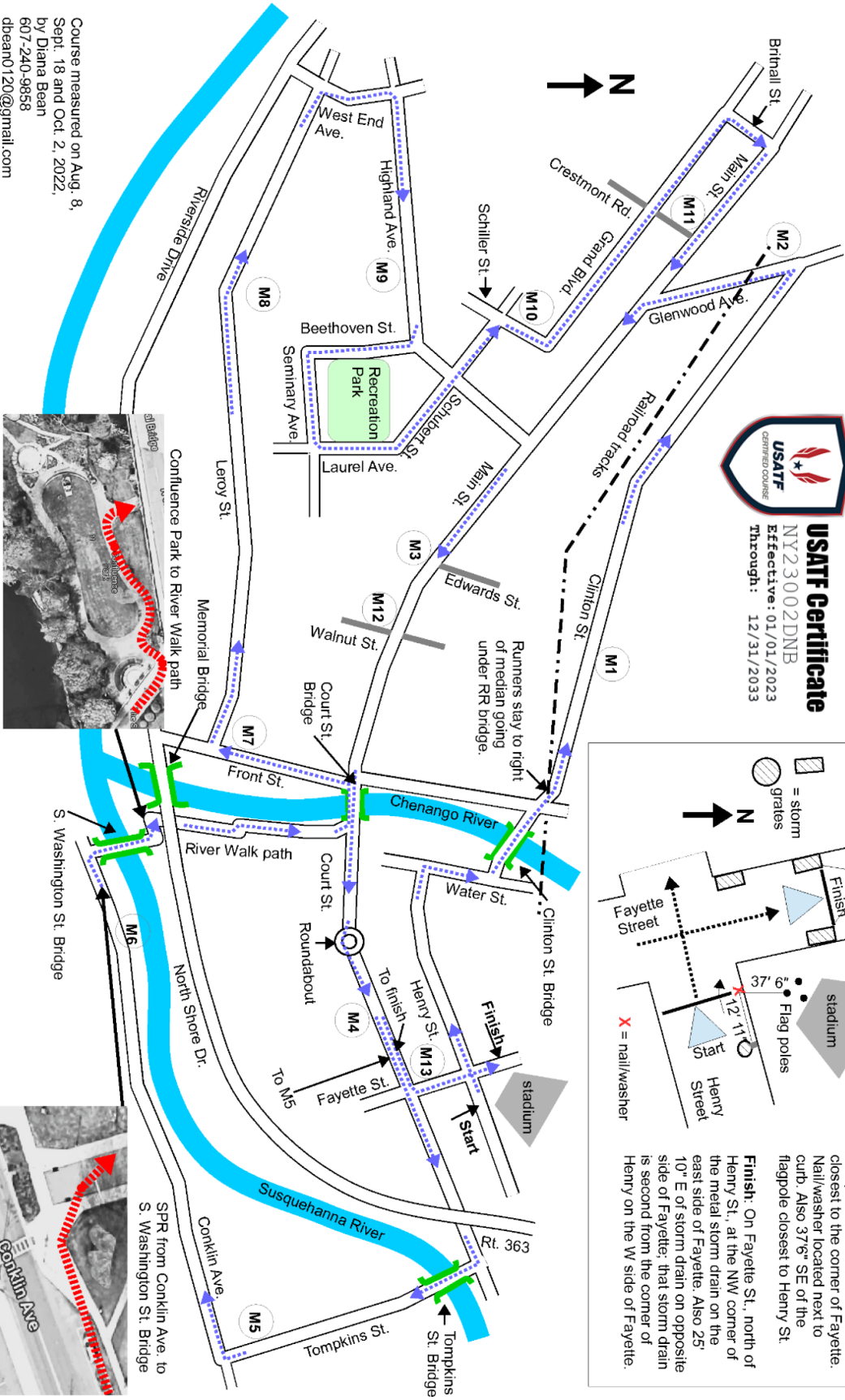

### Start / Finish detail

**Start:** On Henry St. in right-hand turn lane in front of stadium gates. 12' 11" W of the small straight portion (next to curb) of the round storm drain closest to the corner of Fayette. Nail/washer located next to curb. Also 37' 6" SE of the flagpole closest to Henry St.

**Finish:** On Fayette St., north of Henry St., at the NW corner of the metal storm drain on the east side of Fayette. Also 25' 10" E of storm drain on opposite side of Fayette; that storm drain is second from the corner of Henry on the W side of Fayette.

Legend:  
 ◻ = storm grates  
 ○ = flag poles  
 X = nail/washer

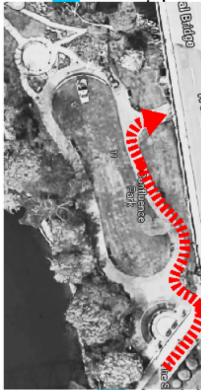

Course measured on Aug. 8,  
 Sept. 18 and Oct. 2, 2022,  
 by Diana Bean  
 607-240-9858  
 dbean0120@gmail.com

**Greater Binghamton Bridge Run Half Marathon 2023**  
**Binghamton, NY**  
**Course description and mile splits**

**Start:** On Henry St. in the right-hand turn lane in front of Mirabito Stadium gates, 12' 11" W of the small straight portion (next to curb) of the round storm drain closest to the corner of Fayette St. PK nail/washer located next to curb. Also 37'6" SE of the flagpole closest to Henry Street.

Head W on Henry St.

Turn R on Water St.

Turn L on Clinton St. and cross Clinton Street Bridge.

Runners stay to the right (running with traffic) when going under the railroad overpass. Continue W on Clinton St.

**M1:** Clinton St., just E side of playground equipment for Boys and Girls Club.

Turn L on Glenwood Ave. and head S.

**M2:** Glenwood Ave., around the corner from Clinton, at the southern edge of the driveway to convenience store parking lot.

Turn L on Main St. and head SE, moving over to the eastbound lane and running with traffic. This is also the shortest route.

**M3:** Main St., on the western edge of the crosswalk across Main St. on the E side of Edwards St.

Continue E on Main St., which becomes Court St. upon crossing the Court Street Bridge. Stay to the R on the Court St. roundabout.

**M4:** Court St., by AVRE, at City of Binghamton City utility pole 2933 before PedX sign.

Turn R on Tompkins St. and cross Tompkins Street Bridge, heading S.

**M5:** Tompkins St., even with the front of the Southside Auto building, just before R turn onto Conklin Ave.

Turn R on Conklin Ave. and head W.

**M6:** Conklin Ave., across from Servepro lot, at "back in only" parking sign closest to City of Binghamton utility pole 3639.

From Conklin Ave., runners can step up on the curb for the shortest route to the S end of the South Washington Street Bridge (see photo inset on map).

Run N on South Washington Street Bridge  
Turn L to follow pathway into Confluence Park.  
Turn R on pathway under Memorial Bridge, heading N on River Walk. (see photo inset on map).  
Stay to R on River Walk and exit onto Court St.  
Turn L and run W over Court Street Bridge.  
Turn L to run S on Front St.

**M7:** Front St., north edge of driveway to M&T.  
Turn R onto Leroy St. and head W.

**M8:** Leroy St., at front walkway to 172 Leroy.  
Turn R at West End Ave. heading N.  
Turn R at Highland Ave. and head E.

**M9:** Highland Avenue, at W side of 23 Highland.  
Turn R on Beethoven St.  
Turn L on Seminary Ave.  
Turn L on Laurel Ave.  
Turn L on Schubert Ave.  
Turn R on Schiller St.

**M10:** Schiller St., at driveway between 27 and 29 Schiller  
Turn L on Grand Blvd. heading NW  
Turn R on Britnall St.  
Turn R on Main St., heading SE

**M11:** Main St. at E side of the corner of Crestmont Rd.

**M12:** Main St. at E side of the corner of Walnut.  
Main St. becomes Court St. at the Court Street Bridge. Stay to the right on the Court St.  
roundabout.  
Turn L on Fayette St.

**M13:** Fayette St., at center of small parking lot SE and next to 42 Fayette

**Finish:** On Fayette St., north of Henry St., at the NW corner of the metal storm drain on the east side of Fayette and closest to Henry. Also 25' 10" E of storm drain on opposite side of Fayette; that storm drain is the second one from the corner of Henry and Fayette on the W side of Fayette.

Measured Aug. 8, Sept. 18 and Oct. 2, 2022 by Diana Bean  
607-240-9858 / dbean0120@gmail.com