



**Road Running Technical Council
USA Track & Field**

Measurement Certificate



Name of the course Disneyland Half Marathon 2026 Distance 21.0975 km
 Location (state) CA (city) Anaheim
 Type of course: Road Race
 Measuring Methods: Bicycle
 Measured By Todd E. Byers, 44444 N Shangri La Ln., New River, AZ 85087, byers_todd2@hotmail.com, 562-665-1485
 Race Contact Andy Bone, 3446 Crane Court, Claremont CA 91711, andy@spectrumsports.net, 909-407-6347
 Date(s) when course measured: 11/18/2025
 Number of measurements of entire course: 2 Course Configuration: point-to-point
 Elevation (meters above sea level) Start 41.00 Finish 42.00 Lowest 37.00 Highest 48.00
 Straight line distance between start and finish 182m Drop -0.05 m/km Separation 0.86 %
 Type of surface: Paved 100 % Dirt 0 % Gravel 0 % Grass 0 % Track 0 %
 Effective date of certification: December 25, 2025 Certification code: CA25035TEB

Note to Race Director: Use this Certification Code in all public announcements relating to your race.

Be It Officially Noted That

Based on examination of data provided by the above named measurer, the course described above and in the map attached is hereby certified as reasonably accurate in measurement according to the standards adopted by the Road Running Technical Council. If any changes are made to the course, this certification becomes void, and the course must then be recertified.

Verification of Course --- In the event a National Open Record is set on the course, or at the discretion of USA Track & Field, a verification measurement may be required to be performed by a member of the Road Running Technical Council. If such a remeasurement shows the course to be short, then all pending records will be rejected and the course certification will be cancelled.

This certification expires on December 31 of the year: **2035**

AS NATIONALLY CERTIFIED BY:

Date: January 15, 2026

Todd E. Byers - USATF/RRTC Certifier - 44444 N Shangri La Ln., New River AZ 85087
 (562) 665-1485 - byers_todd2@hotmail.com

Disneyland Half Marathon 2026 Anaheim CA

Measured on 11/18/2025 by Todd E. Byers (byers_todd2@hotmail.com) & Andrew Bone (andy@spectrumsports.net)
 Map drawn by: June Sterling
 Measurements are shortest possible route (SPR) unless otherwise noted.
 Map not to scale. See details A,B and C and mile location descriptions on following pages. Calibration course: CA24028TEB (1000 feet).



USATF Certificate
 CA25035TEB
 Effective: 12/25/2025
 Through: 12/31/2035

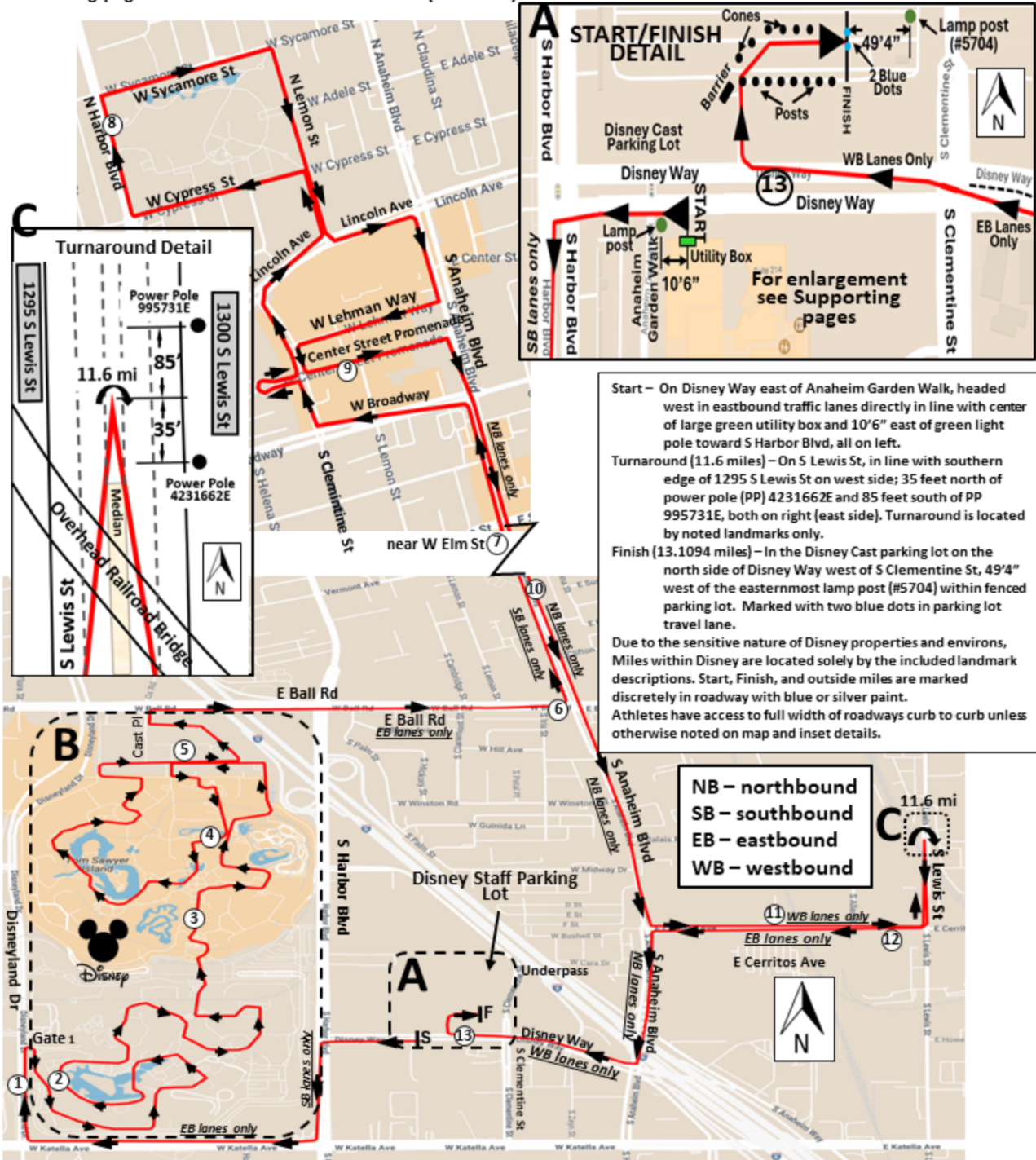

Start – On Disney Way east of Anaheim Garden Walk, headed west in eastbound traffic lanes directly in line with center of large green utility box and 10'6" east of green light pole toward S Harbor Blvd, all on left.

Turnaround (11.6 miles) – On S Lewis St, in line with southern edge of 1295 S Lewis St on west side; 35 feet north of power pole (PP) 4231662E and 85 feet south of PP 995731E, both on right (east side). Turnaround is located by noted landmarks only.

Finish (13.1094 miles) – In the Disney Cast parking lot on the north side of Disney Way west of S Clemantine St, 49'4" west of the easternmost lamp post (#5704) within fenced parking lot. Marked with two blue dots in parking lot travel lane.

Due to the sensitive nature of Disney properties and environs, Miles within Disney are located solely by the included landmark descriptions. Start, Finish, and outside miles are marked discretely in roadway with blue or silver paint. Athletes have access to full width of roadways curb to curb unless otherwise noted on map and inset details.

NB – northbound
SB – southbound
EB – eastbound
WB – westbound

Disneyland Half Marathon 2026 Start and Finish Detail Inset A

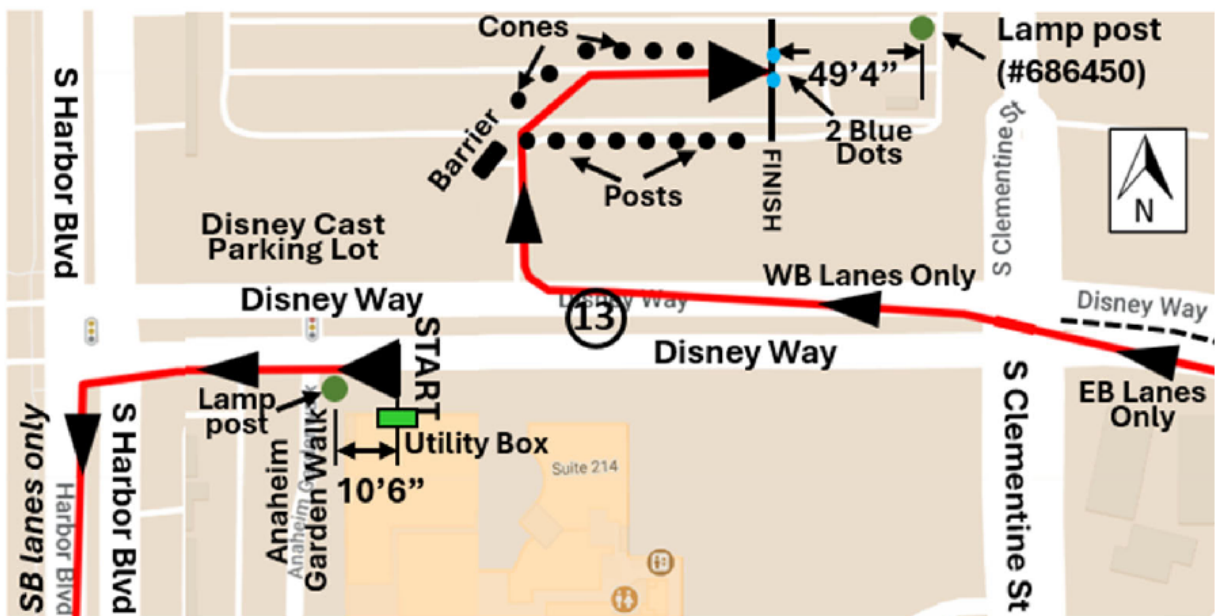

Disneyland Half Marathon 2026 within Disney Inset B

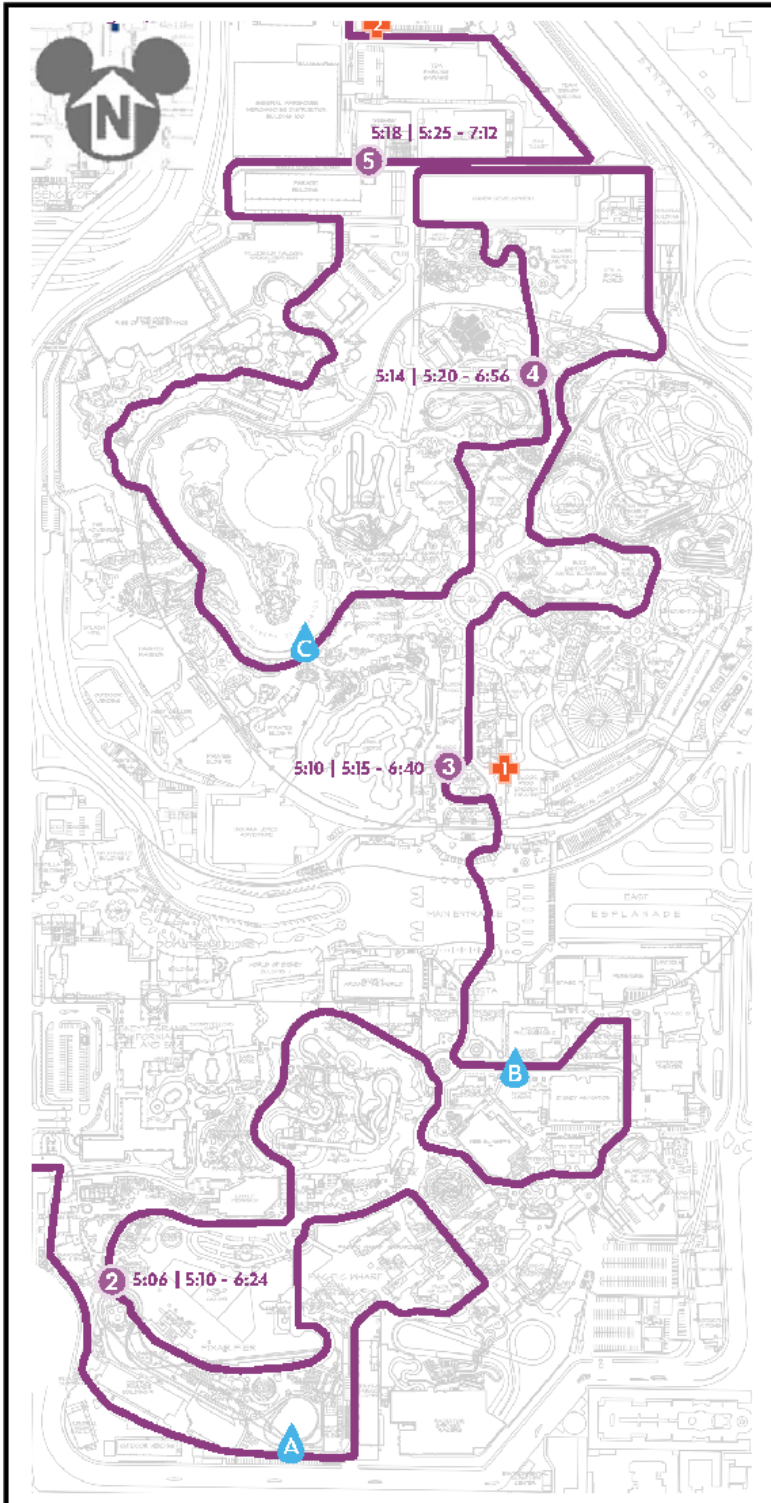

Throughout Disney properties, Measurers were escorted by Disney staff as well as the Race Director and Course Director. Shortest Possible Route (SPR) was followed as closely as possible and was generally unrestricted but with constraints of benches, carts, kiosks, lamp posts, gates, and other structures. Cones and barriers will be placed along route to isolate these obstacles following the measured SPR as accurately as possible.

Disneyland Half Marathon 2026 Turnaround Detail Inset C

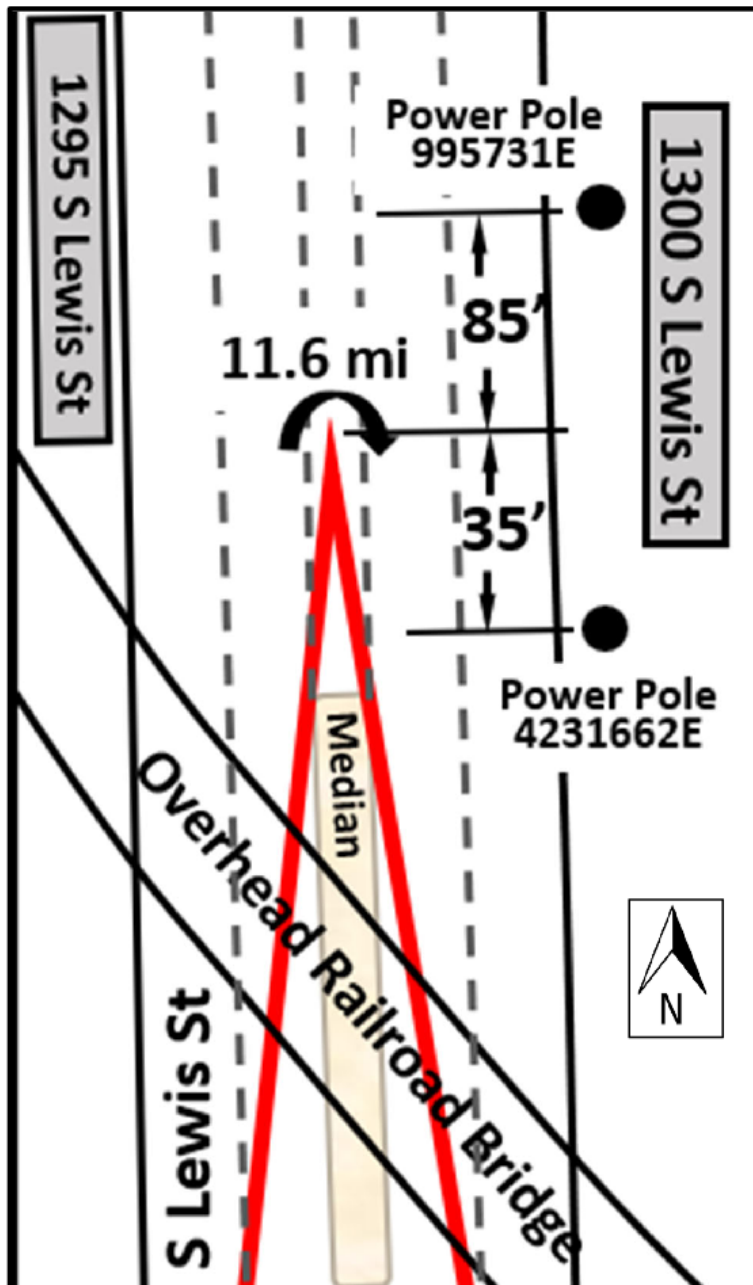

Start, Finish, Turnaround and Mile Locations for Disneyland Half Marathon 2026 - Anaheim CA

Note: Due to the sensitive nature of Disney properties and environs, Miles within Disney are located solely by the landmark descriptions below. Start, Finish, and outside miles are marked discretely with blue or silver paint on right in direction of athlete travel unless otherwise noted.

Start ... On Disney Way east of Anaheim Garden Walk, headed west in eastbound traffic lanes directly in line with center of large green utility box and 10'6" east of green light pole toward S Harbor Blvd, all on left. Marked on left.

Mile 1 ... On Disneyland Dr at northern edge of intersection (northernmost outbound directional arrow) at Gate 11 entrance on right (Downtown Dr on left).

Mile 2 ... At entrance to Silly Symphony Swings as athletes head north around lagoon.

Mile 3 ... At entrance to Emporium Gift Shop on northwest corner (at Christmas tree point), before left (north) turn on to Main Street.

Mile 4 ... At opening along the pathway behind the Fantasy Faire Gift Shop as athletes are headed south (away from It's a Small World).

Mile 5 ... In BOH eastbound, 30 feet past (east of) STOP line at intersection near electrical plant – across the intersection from Building 6205.

Mile 6 ... On W Ball Rd eastbound in eastbound lanes in left turn pocket before S Anaheim Blvd directly across from McDonald's driveway on north side of W Ball Rd.

Mile 7 ... On S Anaheim Blvd northbound in southbound traffic lanes north of W Santa Ana St, outside the main entrance to the community center at 405 S Anaheim Blvd on left.

Mile 8 ... On N Harbor Blvd northbound in northbound lanes, in line with the westernmost basketball hoop on the west side of Pearson Park on right.

Mile 9 ... Eastbound on W Center St Promenade in front of 205 W Center St Promenade, 10 feet before (west of) temporary patio on north side.

Mile 10 ... On S Anaheim Blvd, south of Vermont Ave, southbound in northbound traffic lanes, between 916 and 918 S Anaheim Blvd and 30 feet south of beginning of the grassy part of the center median (directly at first palm tree in median) on right.

Mile 11 ... On E Cerritos Ave eastbound in westbound traffic lanes, adjacent to "Free Live Entertainment" advertising sign on left (north) side of E Cerritos Ave.

Turnaround (11.6 miles) ... On S Lewis St, in line with southern edge of 1295 S Lewis St on west side; 35 feet north of power pole (PP) 4231662E and 85 feet south of PP 995731E, both on right (east side).

Mile 12 ... On E Cerritos Ave westbound in eastbound traffic lanes, 300 feet before (east of) driveway to Crenshaw Lumber, in line with "Danger Electric Shock" sign and electrical service manhole painted #TO TV-235 on southern curb.

Mile 13 ... On Disney Way westbound in westbound traffic lanes, west of S Clementine St, 6 feet west of second green lamp post west of S Clementine St and 225 feet west of first manhole cover west of S Clementine St.

Finish - Mile 13.1094 ... In the Disney Cast parking lot on the north side of Disney Way west of S Clementine St, 49'4" before (west of) the easternmost lamp post #5704. Marked with two blue dots in parking lot travel lane.