



*Road Running Technical Council
USA Track & Field
Measurement Certificate*



Name of the course Love Run Half Marathon 2026 (Pre-Verified) Distance 21.0975 km

Location (state) PA (city) Philadelphia

Type of course: Road Race

Measuring Methods: Steel Tape & Bicycle

Measured By Matt Slocum, PO Box 3005, Montclair, NJ 07043, matt@precisioncoursedesign.com, 917-725-1709

Race Contact Larry Redrow, CGI Events, lredrow@cgievents.com

Date(s) when course measured: 1/17/2026

Number of measurements of entire course: 2 Course Configuration: complex of different loops with separate S/F

Elevation (meters above sea level) Start 9.00 Finish 14.00 Lowest 6.00 Highest 36.00

Straight line distance between start and finish 462m Drop -0.24 m/km Separation 2.19 %

Type of surface: Paved 100 % Dirt 0 % Gravel 0 % Grass 0 % Track 0 %

Effective date of certification: January 28, 2026 Certification code: PA26002MNS

Note to Race Director: Use this Certification Code
in all public announcements relating to your race.

Be It Officially Noted That

Based on examination of data provided by the above named measurer, the course described above and in the map attached is hereby certified as reasonably accurate in measurement according to the standards adopted by the Road Running Technical Council. If any changes are made to the course, this certification becomes void, and the course must then be recertified.

Verification of Course --- In the event a National Open Record is set on the course, or at the discretion of USA Track & Field, a verification measurement may be required to be performed by a member of the Road Running Technical Council. If such a remeasurement shows the course to be short, then all pending records will be rejected and the course certification will be cancelled.

This certification expires on December 31 of the year: **2036**

AS NATIONALLY CERTIFIED BY:

Date: January 28, 2026

Matt Slocum - USATF/RRTC Certifier - PO Box 3005, Montclair NJ 07043
(917) 725-1709 - matt@precisioncoursedesign.com



Love Run Half Marathon 2026 Pre-Verified

21.0975 km | Philadelphia, PA

START: 39.961628, -75.175458 | In the NW-bound inner lanes of Benjamin Franklin Pkwy, SE of Eakins Oval and just before (NW of) the intersection with N 22nd St. Even with the center of the Iceland flagpole and 78 feet past (SE of) the center of the India flagpole. Please see the Start Detail Diagram.

TURNAROUND: (15.02715 km/9.337438 miles): 40.004164, -75.192643 | On MLK Dr, 6'6" before (S of) the center of light pole #F-10 and 16'4" past (N of) Storm Drain Inlet Pole #W129 (both on the E side of the road). Please see the Turnaround Detail Diagram.

FINISH: 39.964530, -75.179499 | Even with the center of the Art Museum steps and the center of the three storm grates embedded in the sidewalk. 111 feet past (NE of) the trailing (NE) edge of the storm drain on the SW side of the steps (near light pole "Pkwy Location B-2") and 58'3" before (SW of) the leading (SW) edge of the storm drain near the trailing (NE) edge of the steps. Please see the Finish Detail Diagram.

COURSE RESTRICTIONS:
 On B.F. Pkwy, runners stay left of the centerline, center buffer zones, and center dividers at all times. Runners may not use the outer lanes (outside of the six inner lanes) on B.F. Pkwy.
 On MLK Dr, runners are restricted to the S-bound lane (including yellow buffer zones) while running N (approaching the T/A) and to the N-bound lane (incl. yellow buffer zones) while running S (after the T/A). MLK Dr is unrestricted btwn the N edge of the intersection with Black Rd and the S edge of the intersection with Sweetbriar Dr.

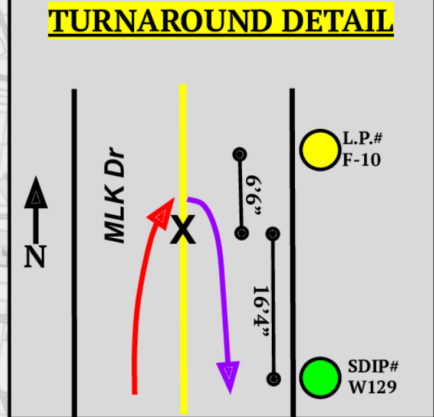
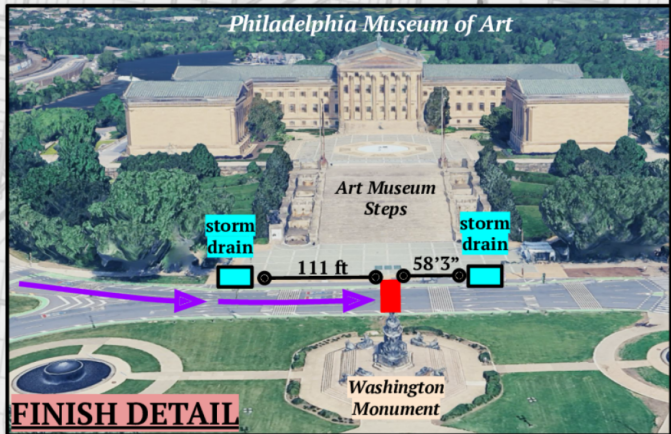

Blue = Start to Mile 3
 Red = Mile 3 to Turnaround
 Purple = Turnaround to Finish
 See Supplemental Pages for Detail Diagrams A + B, Intermediate Split Descriptions, and Turn by Turn

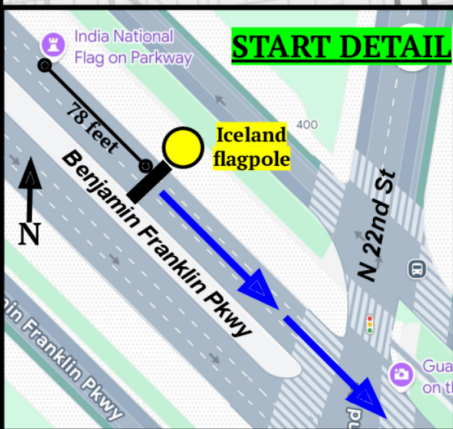
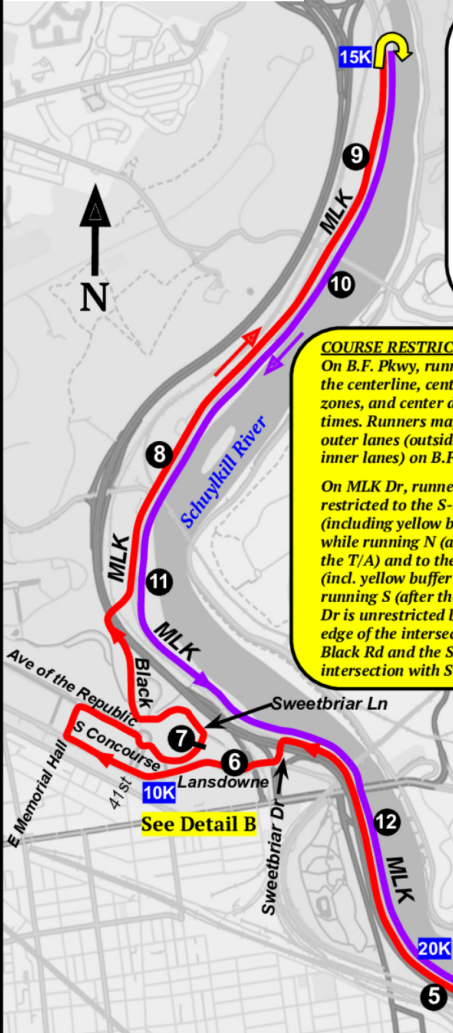

Measured by Dan Brannen (WA-A) + Matthew Slocum (WA-B) | 17 January 2026 | danbrannen@earthlink.net | matt@precisioncoursedesign.com
 Except as noted in the Course Restrictions, this course was measured using the full width of the road and the shortest possible route

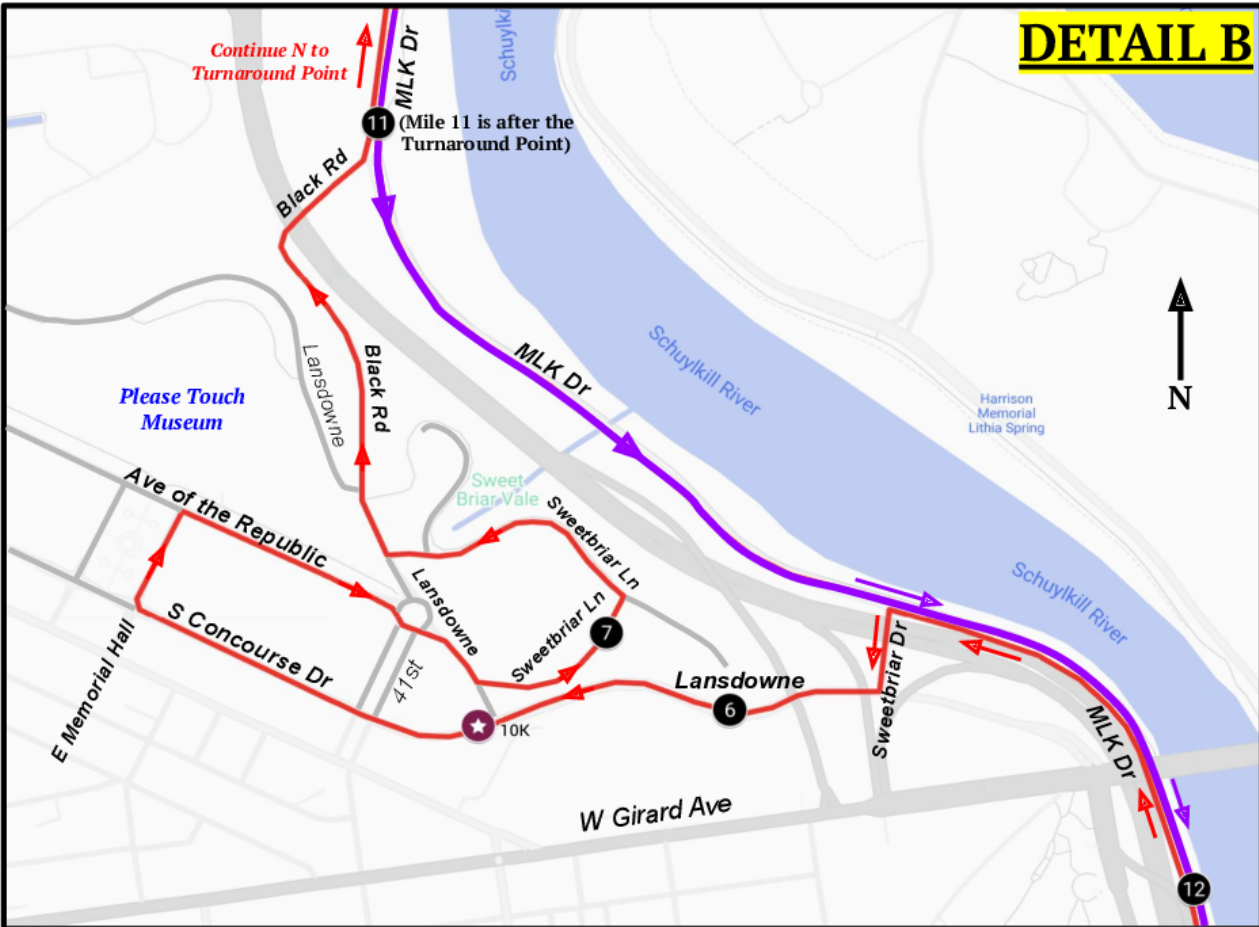
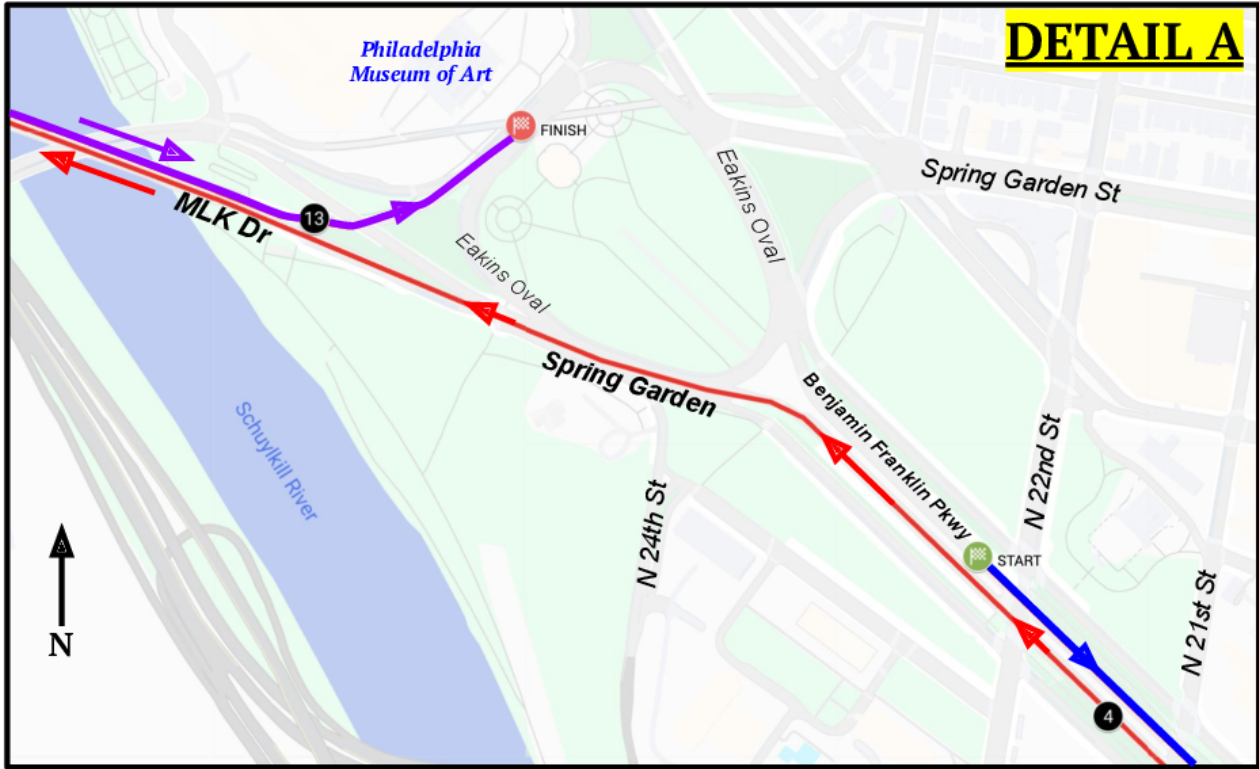

Love Run Half Marathon 2026 Pre-Verified

Turn by Turn

- Start running SE in the NW-bound inner lanes on Benjamin Franklin Pkwy (see Detail A and the Start Detail Diagram on the primary map page)
- Bear left (clockwise) around Logan Circle
- Continue running SE in the NW-bound lanes of Benjamin Franklin Pkwy
- Bear left onto Arch St
- Right onto N 6th St
- Right onto Market St
- Left onto E Penn Square
- Bear right onto S Penn Square
- Bear right onto S 15th St
- Left onto Market St
- Right onto N 20th St
- Right onto JFK Blvd
- Left onto N 16th St
- Left onto Benjamin Franklin Pkwy (running NW in the SE-bound lanes)
- Bear left (clockwise) around Logan Circle
- Continue running NW in the SE-bound inner lanes of Benjamin Franklin Pkwy
- Bear left at Eakins Oval/Spring Garden St (see Detail A)
- Bear left to MLK Dr and the MLK Bridge (counterflow, see Detail A)
- Run N/NW in the S-bound lane of MLK Dr
- Left onto Sweetbriar Dr
- Right onto Lansdowne Dr
- Continue on S Concourse Dr
- Right onto E Memorial Hall Dr (see Detail B)
- Right onto Ave of the Republic
- Bear right at the circle (shortest possible route) and briefly continue on Lansdowne Dr (see Detail B)
- Left onto Sweetbriar Ln, then follow the loop counterclockwise (see Detail B)
- Right onto Lansdowne Dr, then bear right onto Black Rd (see Detail B)
- Left onto MLK Dr, running N in the S-bound lane
- Turnaround, then run S in the N-bound lane of MLK Dr
- *Full width on MLK Dr while running S between the N edge of the intersection with Black Rd and the S edge of the intersection with Sweetbriar Dr only*
- After reaching the S edge of the intersection with Sweetbriar Dr, run S in the N-bound lane of MLK Dr
- Bear left after crossing the MLK bridge to run counterflow up the MLK entrance ramp (see Detail A)
- Continue directly to the Finish (See Detail A and the Finish Detail Diagram on the primary map page)

LOVE RUN HALF MARATHON 2026 (PRE-VERIFIED)

Intermediate Splits

START: [39.961628, -75.175458](#) | In the NW-bound inner lanes of Benjamin Franklin Pkwy, SE of Eakins Oval and just before (NW of) the intersection with N 22nd St. Even with the center of the Iceland flagpole and 78 feet past (SE of) the center of the India flagpole. Please see the Start Detail Diagram.

Mile 1: [39.954066, -75.160404](#) | On Arch St, between N 13th St and N 12th St. 15 feet before (W of) the center of the doorway for building #1218 (on the runners' right).

Mile 2: [39.951536, -75.156238](#) | On Market St, just before (E of) 10th St. 21 feet past (W of) the trailing (W) edge of bus stop kiosk #30081. Said bus stop is the middle of the three such kiosks between 9th St and 10th St.

Mile 3: [39.954270, -75.173000](#) | On N 20th St, just before (S of) the right turn onto John F. Kennedy Blvd. 7 feet before the fire hydrant on the runners' right and 10 feet past (N of) the trailing (N) curb line of the alley on the runners' right (Commerce St).

5 km: [39.954369, -75.171231](#) | On JFK Blvd, 2'6" past (E of) the trailing (E) edge of the crosswalk on the trailing (E) side of the intersection with N 19th St.

Mile 4: [39.960553, -75.174312](#) | In the SE-bound inner lanes of Benjamin Franklin Pkwy, between N 21st St and N 22nd St. 14'4" before (SE of) the Norway flagpole (on the runners' left).

Mile 5: [39.968093, -75.190061](#) | In the SE-bound lane of MLK Dr, 53 feet past (NW of) L.P. #A-13 (on the runners' right). Also near the last (northernmost) boathouse on the opposite side of the river.

Mile 6: [39.975973, -75.200741](#) | On Lansdowne Dr, shortly after the right turn from Sweetbriar Dr. Just past (W of) all of the bridge overpasses and 47 feet past utility pole (U.P.) #61883 (on the runners' left).

10 km: [39.975766, -75.204653](#) | On S Concourse Dr, just past (W of) the trailing (W) edge of the intersection with Lansdowne Dr. 29 feet past the storm drains on the NW and SW corners of said intersection.

Mile 7: [39.976924, -75.202663](#) | On Sweetbriar Lane, on the E side of the small circular loop. 36 feet before (S of) the fire hydrant on the runners' right.

Mile 8: [39.987676, -75.204252](#) | In the S-bound lane of MLK Dr, just past (N of) Montgomery Dr, Belmont Stables, and the Columbia Bridge (railroad bridge). 12 feet before (S of) L.P. #D-05 (on the runners' right).

Mile 9: [39.999363, -75.193362](#) | In the S-bound lane of MLK Dr, before (S of) the Turnaround and just past (N of) the northernmost of the two access roads to the Strawberry Mansion Bridge. 45 feet before (S of) L.P. #E-21 (on the runners' right).

15 km: [40.003916, -75.192642](#) | *In the S-bound lane of MLK Dr, just before (S of) the Turnaround Point. 18 feet before L.P. #F-09 (on the runners' right).*

TURNAROUND (15.02715 km/9.337438 miles): [40.004164, -75.192643](#) | On MLK Dr, 6'6" before (S of) the center of L.P. #F-10 and 16'4" past (N of) Storm Drain Inlet Pole #W129 (both on the E side of the road). Please see the Turnaround Detail Diagram.

Mile 10: [39.995190, -75.196213](#) | In the N-bound lane of MLK Dr, after the turnaround and just past (S of) the Strawberry Mansion Bridge overpass. 25 feet past Storm Drain Inlet Pole #W106 (on the runners' right) and just before (N of) the unmarked L.P. on the runners' left.

Mile 11: [39.983235, -75.206210](#) | In the N-bound lane of MLK Dr, just before (N of) the intersection with Black Rd. 8 feet before Storm Drain Inlet Pole #W059 (on the runners' left).

Mile 12: [39.973747, -75.193537](#) | In the N-bound lane of MLK Dr, 10 feet before (N of) L.P. #A-29 (on the runners' left).

20 km: [39.968284, -75.190270](#) | *In the NW-bound lane of MLK Dr, 17 feet past (S of) L.P. #A-14 (on the runners' left).*

Mile 13: [39.963905, -75.181316](#) | On the MLK entrance ramp, just before (NW of) the Spring Garden St overpass. 2'10" before (NW of) the storm drain (on the runners' left) and 10 feet past (SE of) the trailing (E) edge of the crosswalk for the trail connector (a.k.a. trail crossing).

FINISH: [39.964530, -75.179499](#) | Even with the center of the Art Museum steps and the center of the three storm grates embedded in the sidewalk. 111 feet past (NE of) the trailing (NE) edge of the storm drain on the SW side of the steps (near light pole "Pkwy Location B-2") and 58'3" before (SW of) the leading (SW) edge of the storm drain near the trailing (NE) edge of the steps. Please see the Finish Detail Diagram.