



**Road Running Technical Council  
USA Track & Field**

# **Measurement Certificate**



Name of the course Rehoboth Half Marathon 2024 (31% Unpaved) Distance 21.0975 km  
 Location (state) DE (city) Rehoboth Beach  
 Type of course: Road Race  
 Measuring Methods: Bicycle  
 Measured By Jane Parks, 8606 Wiese Rd, Brecksville, OH 44141, janehp3+ctcert@gmail.com, 973-349-0033  
 Race Contact Mary Beth Hutton, Rehoboth Beach Running Company, 302-227-4848, mbhutton314@gmail.com  
 Date(s) when course measured: November 4, 2024  
 Number of measurements of entire course: 2 Course Configuration: Point to Point  
 Elevation (meters above sea level) Start 4.00 Finish 6.00 Lowest 1.00 Highest 9.00  
 Straight line distance between start and finish 818m Drop -0.09 m/km Separation 3.88 %  
 Type of surface: Paved 69 % Dirt 0 % Gravel 31 % Grass 0 % Track 0 %  
 Effective date of certification: November 27, 2024 Certification code: DE24006JHP

Note to Race Director: Use this Certification Code in all public announcements relating to your race.

## ***Be It Officially Noted That***

Based on examination of data provided by the above named measurer, the course described above and in the map attached is hereby certified as reasonably accurate in measurement according to the standards adopted by the Road Running Technical Council. If any changes are made to the course, this certification becomes void, and the course must then be recertified.

**Verification of Course ---** In the event a National Open Record is set on the course, or at the discretion of USA Track & Field, a verification measurement may be required to be performed by a member of the Road Running Technical Council. If such a remeasurement shows the course to be short, then all pending records will be rejected and the course certification will be cancelled.

***This certification expires on December 31 of the year:*** **2034**

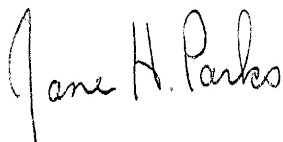

**AS NATIONALLY CERTIFIED BY:**

Date: November 27, 2024

Jane Parks - USATF/RRTC Certifier - 8606 Wiese Rd, Brecksville OH 44141  
 (973) 349-0033 - janehp3+ctcert@gmail.com

# REHOBOTH HALF MARATHON 2024 (31% UNPAVED)

21.0975 km | Rehoboth Beach, DE

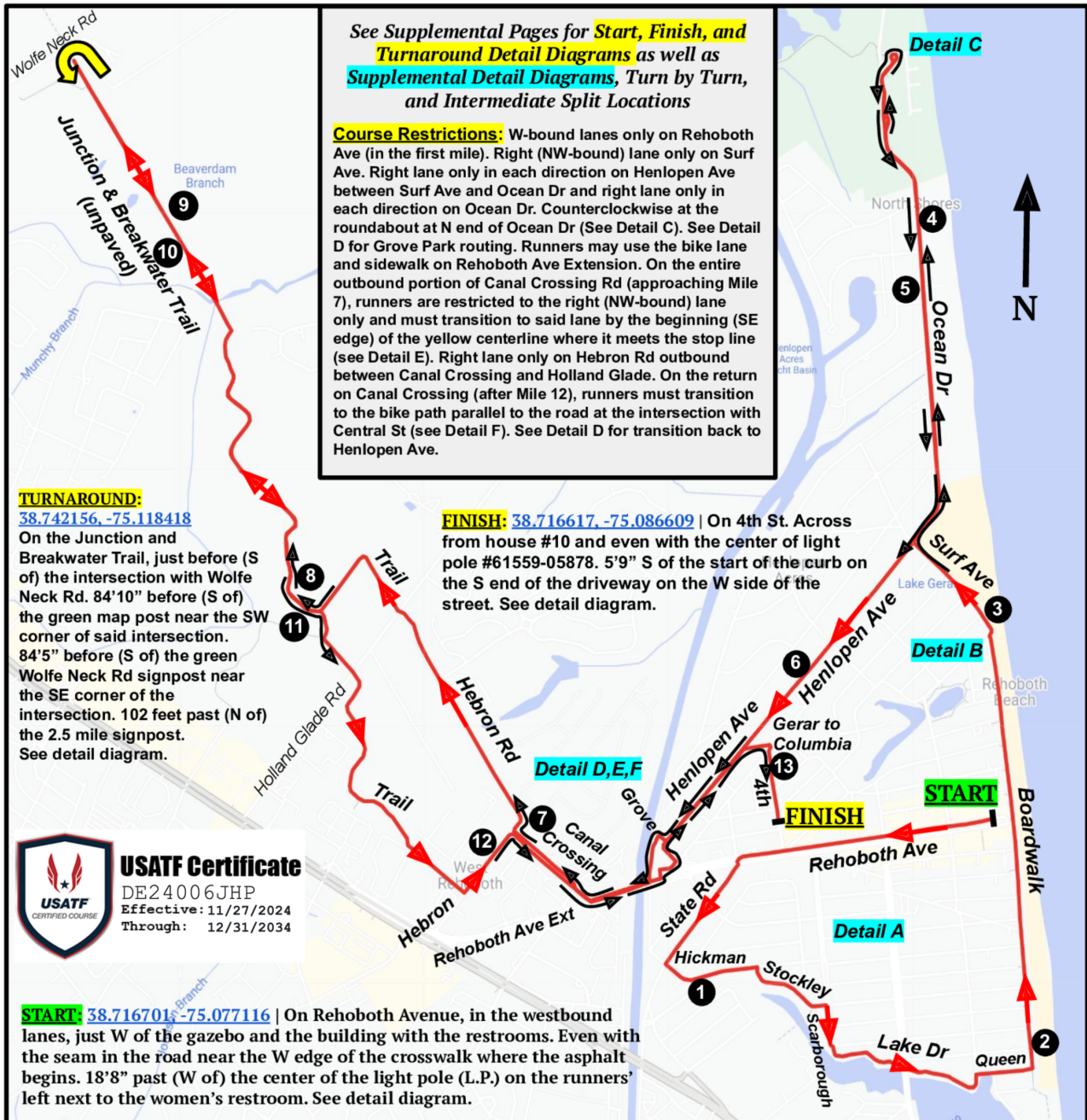

Measured by Jane Parks (WA-A) + Matthew Slocum (WA-B) | 4 November 2024  
 janehp3@gmail.com  
 precisioncoursedesign@gmail.com

Except as noted in the Course Restrictions, this course was measured using the full width of roads/paths and the shortest possible route.

## **Rehoboth Half Marathon 2024 (31% Unpaved)**

### ***Turn by Turn and Course Restrictions***

- Start running W on Rehoboth Ave (**westbound lanes only**) (**see Start Detail**)
- Left onto State Rd at the opening in the median
- Left onto Hickman St
- Right onto Stockley St
- Right onto Scarborough Ave
- Bear left/continue onto Lake Dr
- Bear right to continue on Lake Dr
- Right onto Queen St
- Continue straight towards the Boardwalk, then left onto the Boardwalk. **Runners must remain on the boardwalk and may not cut through the sand on the left turn.**
- Continue running N at the northern end of the Boardwalk onto the sidewalk (SPR)
- At the crosswalk, turn right (from the sidewalk) onto Surf Ave (**right lane only on Surf Ave** | **see Detail Diagram B**)
- Right onto Henlopen Ave (**northbound lane only**)
- Continue onto Ocean Dr (**northbound lane only on Ocean Dr while running N**)
- Stay right (northbound lane) of the center islands near the S end of the parking lots near Gordons Pond Recreation Area (**see Detail Diagram C**)
- Run counterclockwise around the traffic circle at the N end of Ocean Dr (**see Detail Diagram C**)
- Run S on Ocean Dr (**southbound lane only**)
- Stay right (southbound lane) of the center islands near the S end of the parking lots near Gordons Pond Recreation Area (**see Detail Diagram C**). Then remain in southbound lane only on Ocean Dr
- Continue S/SW on Henlopen Ave (**southbound lane only until stop line at leading (N) edge of the intersection with Surf Ave**)
- Right onto Grove St, then left onto Junction and Breakwater Trail (aka Shaw Circle) at the N end of the park to run S through the park (**see Detail Diagram D**)
- Right onto Rehoboth Ave Extension (**runners may use the bike lane and sidewalk on Rehoboth Ave Extension**)
- Right onto Junction and Breakwater Trail
- Right onto Church St, then immediate left onto Canal Crossing Rd (**right lane only on Canal Crossing Rd** | **see Detail Diagram E**)
- Right onto Hebron Rd (**right lane only**)
- Cross Holland Glade Rd and continue directly (N) onto Junction and Breakwater Trail
- Bear right at the Y intersection to continue N on Junction and Breakwater Trail to the Turnaround (just before (S of) Wolfe Neck Rd) (**see Turnaround Detail Diagram**)
- Retrace steps in reverse direction (running S) to the Y intersection
- Bear right at the Y intersection to continue S on Junction and Breakwater Trail directly to Holland Glade Rd
- Cross Holland Glade Rd and continue S on Junction and Breakwater Trail

- Left onto Hebron Rd
- Right onto Canal Crossing Rd
- **Runners must transition to Junction and Breakwater Trail southbound at the intersection with Central St (see Detail Diagram F)**
- Cross Church St and continue SE on Junction and Breakwater Trail
- Left onto Rehoboth Ave Extension (**runners may use the bike lane and sidewalk on Rehoboth Ave Extension**)
- Left at the parking lot between the Museum and the Visitor Center, then second left onto Shaw Circle
- Continue through the park via the routing in detail diagram (**see Detail Diagram D**)
- **Runners use the unpaved transition from Shaw Circle to Henlopen Ave at the opening in the wooden fence directly onto Henlopen Ave. Runners may not transition off the paved path until they reach the leading edge of the light pole on the left (W) side just before (S of) said transition to Henlopen. (see Detail Diagram D)**
- Run NE on Henlopen Ave
- Right onto Gerar St
- Right onto Columbia Ave
- Left onto 4th St (to the Finish) (**see Finish Detail**)



**START:** [38.716701, -75.077116](#) | On Rehoboth Avenue, in the westbound lanes, just W of the gazebo and the building with the restrooms. Even with the seam in the road near the W edge of the crosswalk where the asphalt begins. Also 18'8" past (W of) the center of the light pole on the runners' left next to the women's restroom.

**FINISH:** [38.716617, -75.086609](#) | On 4th St between Kent and Sussex. Across from house #10 (on the runners' left). Even with the center of light pole #61559-05878. The light pole is on the runners' right (W side) and 5'9" after (S of) the start of the curb on the south end of the driveway on the west side of the street.

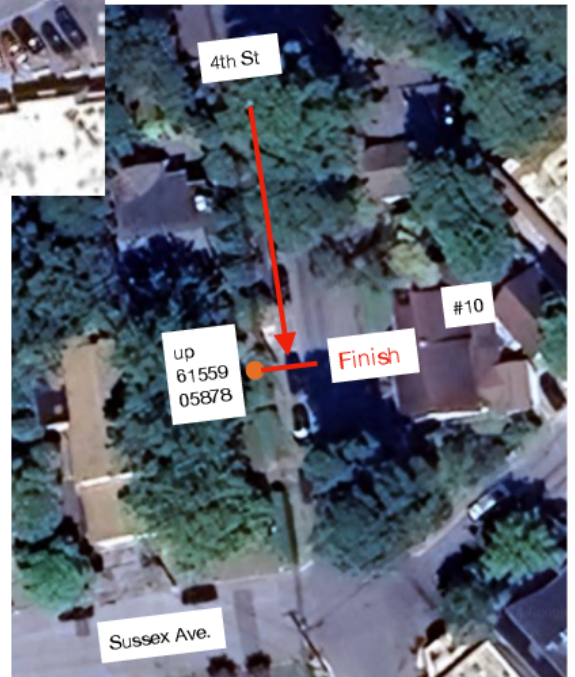

**TURNAROUND POINT:** [38.742156, -75.118418](#) | On the Junction and Breakwater Trail, just before (S of) the intersection with Wolfe Neck Rd. 84'10" before (S of) the green map post near the SW corner of said intersection. 84'5" before (S of) the green Wolfe Neck Rd signpost near the SE corner of intersection. 102 feet past (N of) the 2.5 mile signpost, which is on the runners' right (E side) approaching the T/A point. Marked with metal stakes on both sides of the trail.





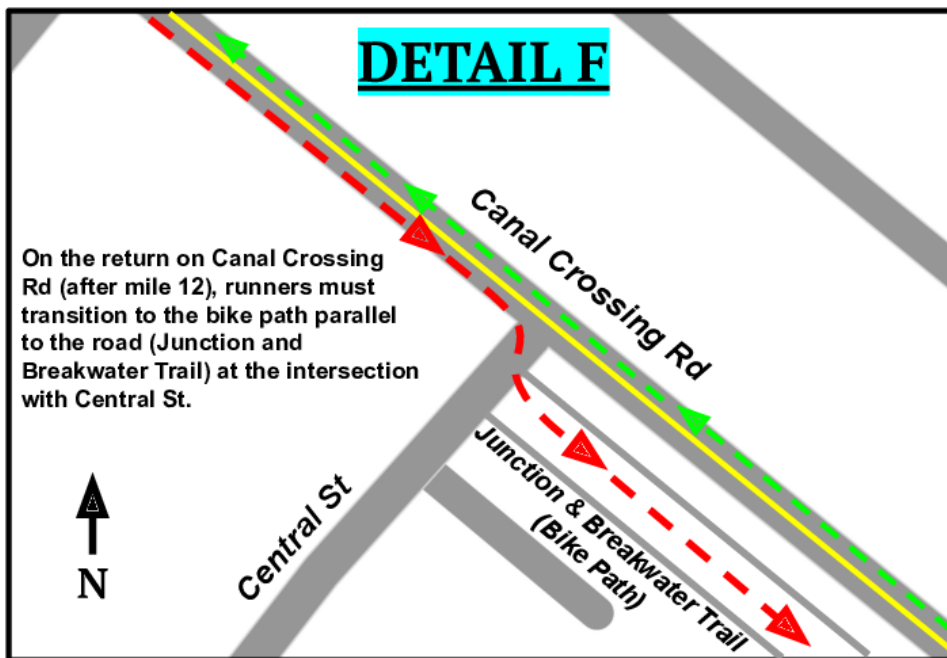
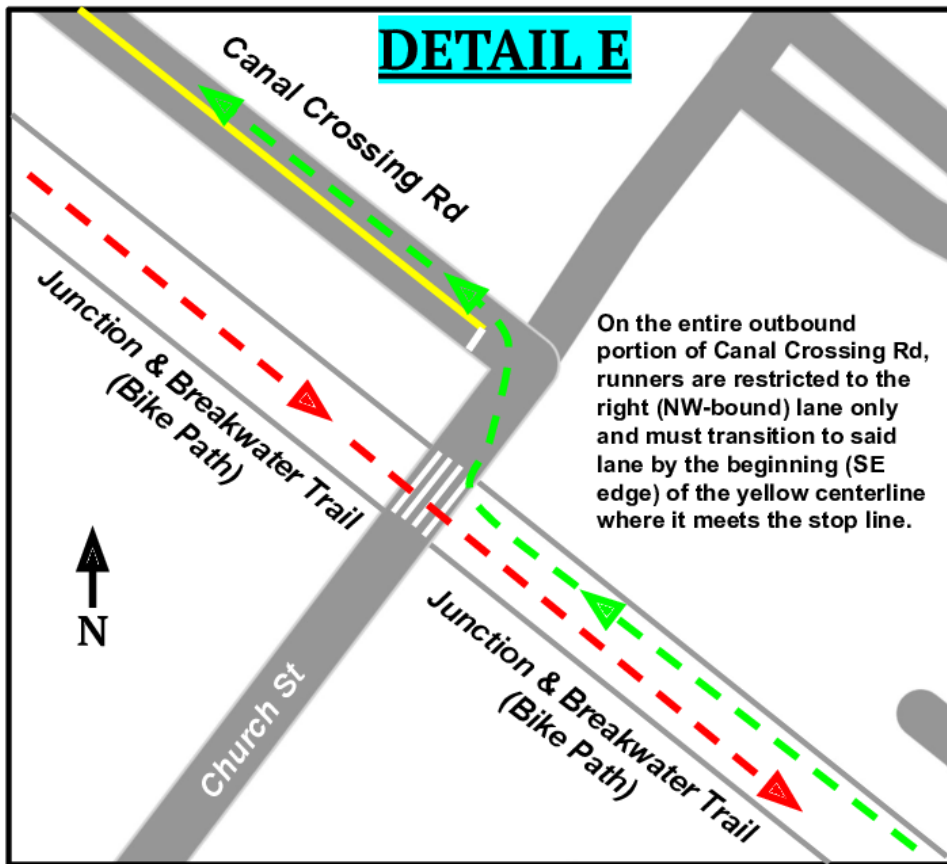

## **Rehoboth Half Marathon 2024 (31% Unpaved)**

### ***Intermediate Splits***

**START:** [38.716701, -75.077116](#) | On Rehoboth Avenue, in the westbound lanes, just W of the gazebo and the building with the restrooms. Even with the seam in the road near the W edge of the crosswalk where the asphalt begins. 18'8" past (W of) the center of the light pole (L.P.) on the runners' left next to the women's restroom. Please see Start Detail Diagram.

**Mile 1:** [38.711434, -75.090157](#) | On Hickman St, even with the center of the double doors for the front porch of house #345 (on the runners' left).

**Mile 2:** [38.709090, -75.075321](#) | On the boardwalk, 2'6" past (N of) the Saint Lawrence St sign on the wooden post next to the boardwalk (on the runners' left) with the number "2" on the sign.

**Mile 3:** [38.723449, -75.077378](#) | On Surf Avenue, near the leading (SE) edge of the intersection with Pennsylvania Ave. Even with the leading edge of the sidewalk on the runners' left and just before (SE of) the yellow fire hydrant (also on the left).

**Mile 4:** [38.736770, -75.080327](#) | On Ocean Drive, in the northbound lane, one foot past (N of) the flagpole in front of house #60 (on the runners' right).

**Mile 5:** [38.734115, -75.080125](#) | On Ocean Dr, in the southbound lane, six feet before (N of) the mailbox for house #20 Ocean Dr (on the runners' left, just before (N of) the intersection with South Rodney Dr).

**Mile 6:** [38.721346, -75.085684](#) | On Henlopen Ave, before (NE of) the intersection with 3rd St. Even with the trailing (SW) edge of house #81 Henlopen Ave (on the runners' right).

**Mile 7:** [38.716204, -75.098423](#) | On Canal Crossing Rd, in the NW-bound lane, approaching the right turn onto Hebron Rd. 11'10" before (SE of) the leading (SE) edge of the pair of storm drains on the runners' right just before (SE of) the stop sign at the intersection with Hebron Rd.

**Mile 8:** [38.724181, -75.108557](#) | On the Junction and Breakwater Trail, running NW towards the Turnaround Point. NW of the Y-intersection and near the beginning of the out and back section of the trail.

**Mile 9:** [38.736340, -75.113815](#) | On the Junction and Breakwater Trail, past (NW of) Munchy Branch and before (SE of) the Turnaround Point.

**TURNAROUND POINT:** [38.742156, -75.118418](#) | On the Junction and Breakwater Trail, just before (S of) the intersection with Wolfe Neck Rd. 84'10" before (S of) the green map post near the SW corner of said intersection. 84'5" before (S of) the green Wolfe Neck Rd signpost near the SE corner of the intersection. 102 feet past (N of) the 2.5 mile signpost, which is on the runners' right (E side) approaching the T/A point. Marked with metal stakes on both sides of the trail. Please see Turnaround Detail Diagram.

**Mile 10:** [38.735658, -75.113236](#) | On the Junction and Breakwater Trail, after the Turnaround Point and NW of Munchy Branch.

**Mile 11:** [38.723668, -75.107752](#) | On the Junction and Breakwater Trail, just before (NW of) the Y intersection at the base (SE corner) of the out and back section.

**Mile 12:** [38.715576, -75.099304](#) | On Hebron Rd, approaching the right turn onto Canal Crossing Rd. 14'4" past (NE of) the chain-link fence running perpendicular to Hebron Rd (fence is on the runners' left), in between Envirotech and the next building NE of Envirotech.

**Mile 13:** [38.718194, -75.086937](#) | On 4th St, just past (S of) the trailing (S) edge of the intersection with Park Ave. 6 feet before (N of) the leading (N) edge of the front door (on 4th) for house #114 Park Ave, which is on the runners' left (near the SE corner of the intersection).

**FINISH:** [38.716617, -75.086609](#) | On 4th St between Kent and Sussex. Across from house #10 (on the runners' left). Even with the center of light pole #61559-05878. Said light pole is on the runners' right (W side) and 5'9" after (S of) the start of the curb on the south end of the driveway on the west side of the street. Please see Finish Detail Diagram.