



**Road Running Technical Council
USA Track & Field**

Measurement Certificate



Name of the course REVEL Big Cottonwood Half Marathon Distance 21.0975 km
 Location (state) UT (city) Salt Lake City
 Type of course: Road Race
 Measuring Methods: Bicycle
 Measured By Austin Pullan, 374 S 671 W, Pleasant Grove, UT 84062, austin@brooksee.com, 435-630-8324
 Race Contact Darrell Phippen, 371 S 671 W Pleasant Grove, UT 84062, (801) 652-3602, darrell@brooksee.com
 Date(s) when course measured: 08/18/2023
 Number of measurements of entire course: 2 Course Configuration: Point-to-point
 Elevation (meters above sea level) Start 2,707.00 Finish 1,330.00 Lowest 1,330.00 Highest 2,707.00
 Straight line distance between start and finish 16670m Drop 65.27 m/km Separation 79.01 %
 Type of surface: Paved 100 % Dirt 0 % Gravel 0 % Grass 0 % Track 0 %
 Effective date of certification: September 7, 2023 Certification code: UT23007TJD

Note to Race Director: Use this Certification Code in all public announcements relating to your race.

Be It Officially Noted That

Based on examination of data provided by the above named measurer, the course described above and in the map attached is hereby certified as reasonably accurate in measurement according to the standards adopted by the Road Running Technical Council. If any changes are made to the course, this certification becomes void, and the course must then be recertified.

Verification of Course --- In the event a National Open Record is set on the course, or at the discretion of USA Track & Field, a verification measurement may be required to be performed by a member of the Road Running Technical Council. If such a remeasurement shows the course to be short, then all pending records will be rejected and the course certification will be cancelled.

This certification expires on December 31 of the year: **2033**

AS NATIONALLY CERTIFIED BY:



Date: September 7, 2023

Trevor Darmstetter - USATF/RRTC Certifier - 803 N Bristol St, Wichita KS 67206
 (316) 833-6050 - trevor@timerguys.com

REVEL Big Cottonwood Half Marathon

21.0975 km

Salt Lake City, UT



USATF Certificate

UT23007TJD
 Effective: 09/07/2023
 Through: 12/31/2033

Course Measured By:
 Austin Pullan and Scott Muhlestein
 8/18/2023

Course measured using
 Shortest Possible Route

Restrictions

- Big Cottonwood Canyon Rd:** Restricted to right lane only
- Big Cottonwood Trail:** No Restrictions
- Holladay Blvd:** Restricted to Left Lane Only
- Big Cottonwood Rd:** Restricted to right lane only
- Van Winkle:** Restricted to Left Lane of North Bound Lanes only
- 5600 E:** Restricted to Left Lane Only

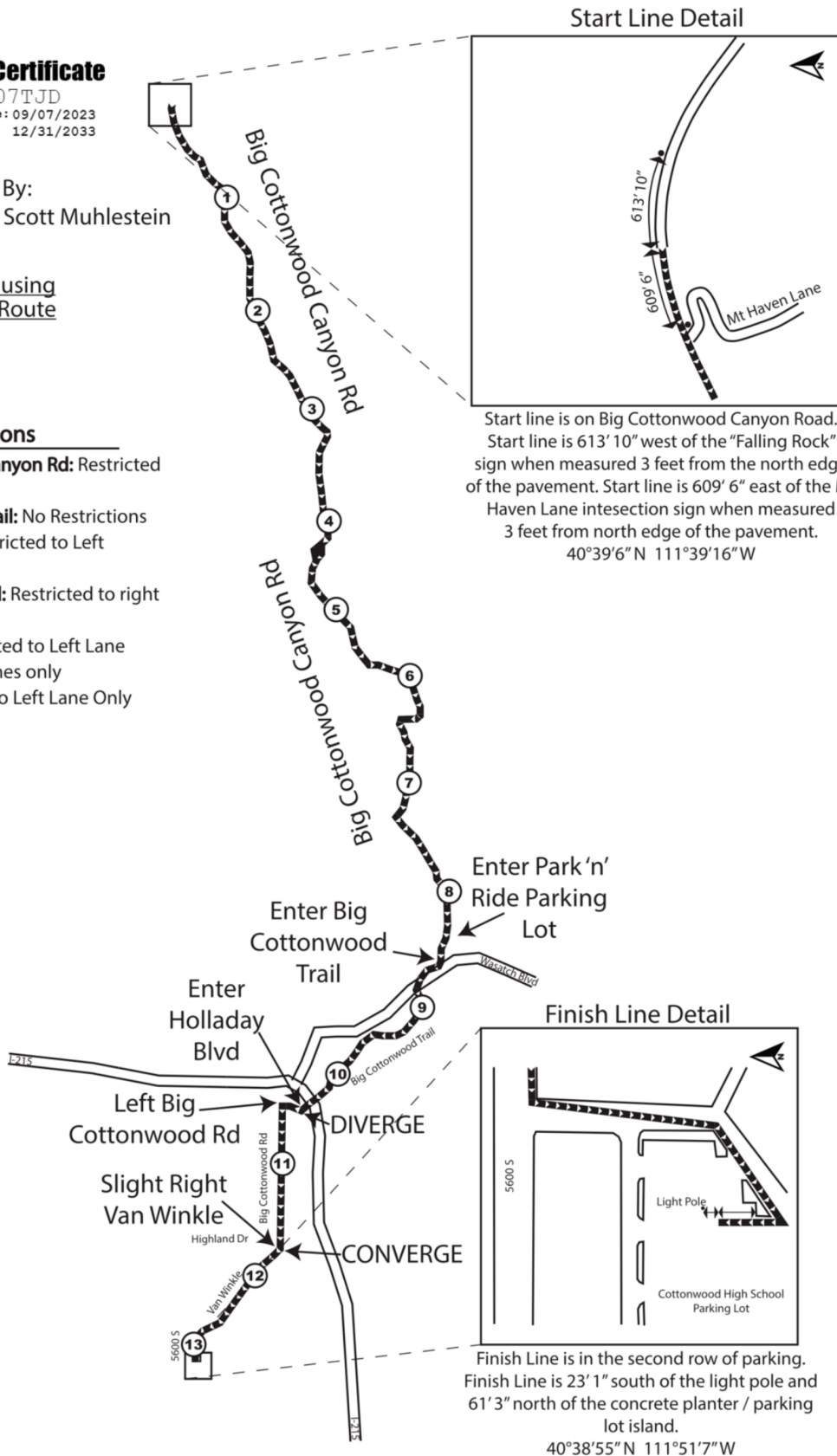

Start Line Detail

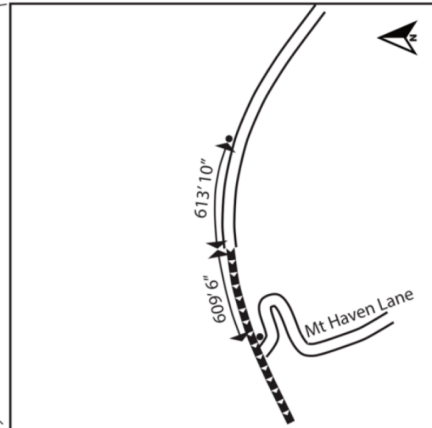

Start line is on Big Cottonwood Canyon Road. Start line is 613' 10" west of the "Falling Rock" sign when measured 3 feet from the north edge of the pavement. Start line is 609' 6" east of the Mt Haven Lane intersection sign when measured 3 feet from north edge of the pavement.
 40°39'6" N 111°39'16" W

Finish Line Detail

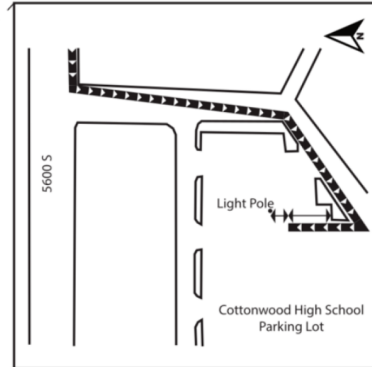

Finish Line is in the second row of parking. Finish Line is 23' 1" south of the light pole and 61' 3" north of the concrete planter / parking lot island.
 40°38'55" N 111°51'7" W



Start	40°39'6" N 111°39'16" W	613' 10" down canyon of "Falling Rock" sign and 609' 6" upcanyon of "Mount Haven Ln" road sign
Mile 1	40°38'44" N 111°40'15" W	Directly in line with the culvert that is about 25' upcanyon from the pull out on the other side of the road
Mile 2	40°38'28" N 111°41'16" W	102' 4" down from the start of the guardrail
Mile 3	40°38'4" N 111°42'14" W	Directly across from pole # 228802
Mile 4	40°38'16" N 111°41'44" W	Directly across the road curves right sign
Mile 5	40°37'51" N 111°44'6" W	208' 1" down from the near edge of driveway with mailbox "6000"
Mile 6	40°37'20" N 111°44'51" W	31' 10" down from the down canyon edge of the guardrail
Mile 7	40°37'25" N 111°45'48" W	Directly in line with manhole cover
Mile 8	40°37'7" N 111°46'46" W	75' 2" down from share the road sign
Mile 9	40°37'19" N 111°47'47" W	14' 2" up from the concrete pillar
Mile 10	40°37'56" N 111°48'25" W	Directly across from the bench
Split Point	40°38'13" N 111°48'43" W	16' 8" past the bollards and 21' 7" before the water meter cover
Mile 11	40°38'19" N 111°49'11" W	148' 1" down from mailbox 2537
Converge Point	40°38'19" N 111°50'3" W	Directly under the traffic lights and 17' 4 inches south of the crosswalk button
Mile 12		No safe place to stop
Mile 13	40°38'57" N 111°51'6" W	3' 1" up from the in ground utility service box
Finish	40°38'55" N 111°51'7" W	23' 1" South of the light pole and 61' 3" North of the garden island

"Down" and "Up" are relative the start and finish. "Down" is further from the start and "Up" is closer to the start