



**Road Running Technical Council  
USA Track & Field**

# **Measurement Certificate**



Name of the course Rocky Run 10mi 2025 Distance 10 mi

Location (state) PA (city) Philadelphia

Type of course: Road Race

Measuring Methods: Bicycle

Measured By James Gusmer, 156 W. 56th St., New York, NY 10019, jgusmer@nyrr.org, 703-346-8196

Race Contact Nate Barnhart, nate@runmfg.com, 773.354.7434

Date(s) when course measured: 10/2/2025, 10/3/2025, 11/7/2025

Number of measurements of entire course: 2 Course Configuration: Keyhole

Elevation (meters above sea level) Start 9.14 Finish 14.63 Lowest 6.10 Highest 61.57

Straight line distance between start and finish 371m Drop -0.34 m/km Separation 2.31 %

Type of surface: Paved 100 % Dirt 0 % Gravel 0 % Grass 0 % Track 0 %

Effective date of certification: November 6, 2025 Certification code: PA25020NP

Note to Race Director: Use this Certification Code in all public announcements relating to your race.

## ***Be It Officially Noted That***

Based on examination of data provided by the above named measurer, the course described above and in the map attached is hereby certified as reasonably accurate in measurement according to the standards adopted by the Road Running Technical Council. If any changes are made to the course, this certification becomes void, and the course must then be recertified.

**Verification of Course ---** In the event a National Open Record is set on the course, or at the discretion of USA Track & Field, a verification measurement may be required to be performed by a member of the Road Running Technical Council. If such a remeasurement shows the course to be short, then all pending records will be rejected and the course certification will be cancelled.

***This certification expires on December 31 of the year:*** **2035**



**AS NATIONALLY CERTIFIED BY:**

Date: November 8, 2025

Nathan Porch - USATF/RRTC Certifier - 2605 LATONA RD, Baltimore MD 21214  
(856) 803-7678 - nathan@getsetgoconsulting.com

**Rocky Run 10M 2025**  
10.0 Miles - Philadelphia, PA

**ROAD USE** (shortest possible route within)  
**START to MLK Jr Dr pole A-02:** Full width  
**MLK Jr Dr:** Right curb to center of road  
*Where applicable:*  
 - Right curb to yellow center line  
 - Right curb to center of buffer between yellow center lines  
 - Right curb to center of left turn only lanes  
 - Just before Falls Bridge: Right curb to center of left lane in northbound traffic  
**Greenland Dr:** Right curb to center line  
**Chamounix Dr before W Ford Rd:** Full width  
**Chamounix Dr after W Ford Rd:** Right curb to center line  
**W Ford Rd:** Full width  
**MLK Jr Dr pole A-02 to FINISH:** Full width

Full landmarks on next page.

**TURNAROUND 2**

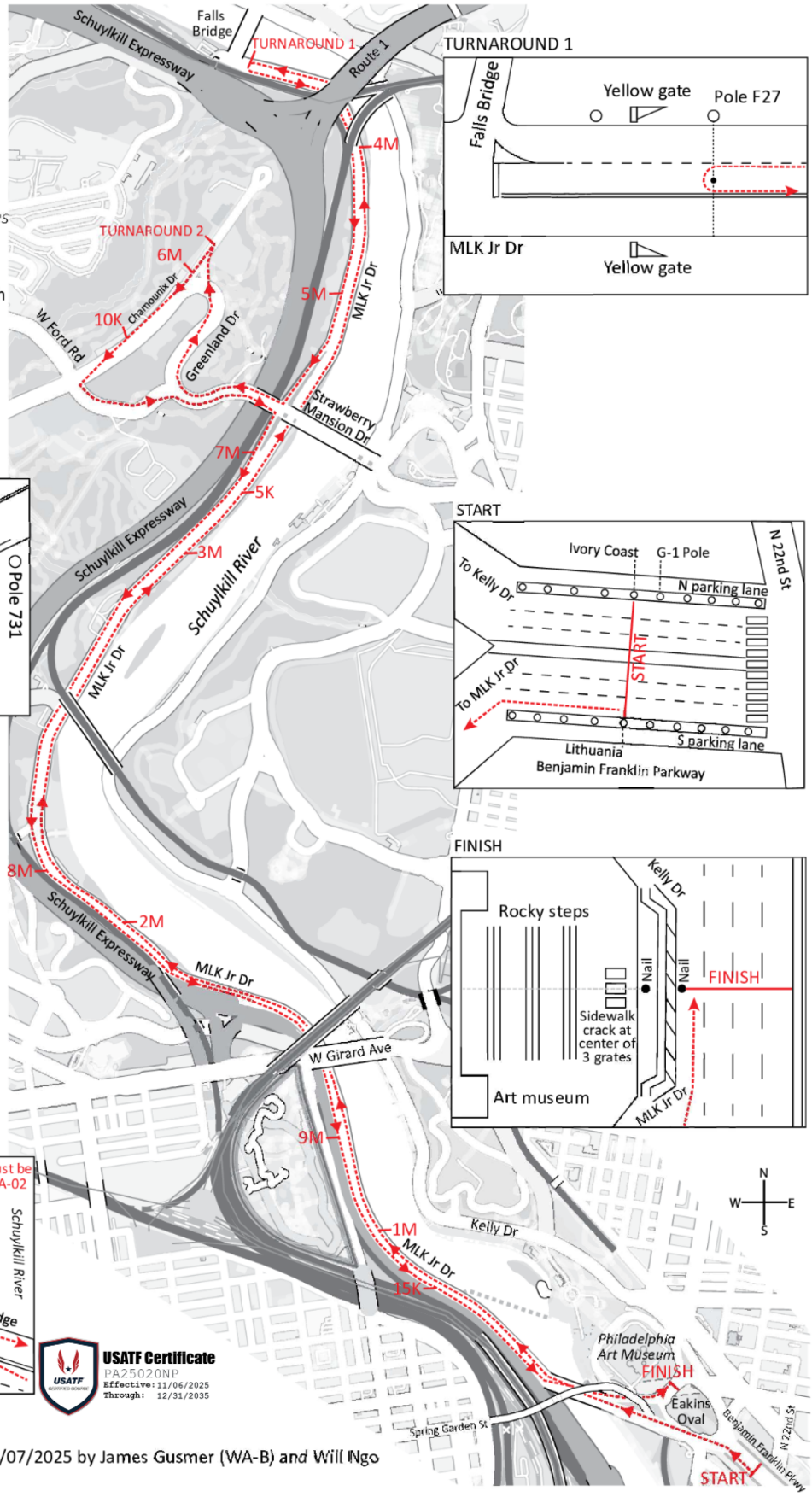
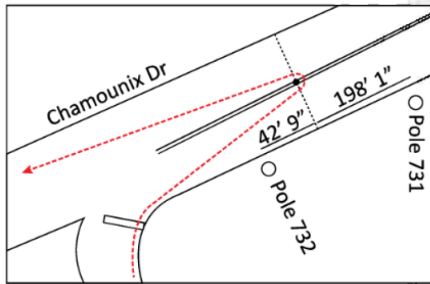

**MLK BRIDGE SPLIT POINT**

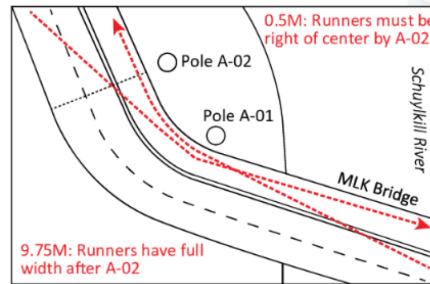

Measured on 10/02/2025, 10/03/2025, 11/07/2025 by James Gusmer (WA-B) and Will Ngo  
 jgusmer@nyrr.org 703-346-8196

**Rocky Run 10M 2025 Landmarks**

**START**

On Benjamin Franklin Pkwy, even with the center of "Ivory Coast" light pole on right; this pole is the first pole west of "Parkway Location G-1" pole, also on the right.

[39.962250, -75.176250](#)

**1M**

On MLK Jr Dr, 36' 9" before (south of) light pole A-19 on the right. [39.969750, -75.192028](#)

**2M**

On MLK Jr Dr, 80' 9" before (south of) the south edge of storm drain W048 on the far left; also 5' 7" after (north of) unmarked light pole on the right. [39.979917, -75.203333](#)

**3M**

On MLK Jr Dr, 47' 2" after (north of) the north edge of storm drain W093 on the right; also even with the northern edge of a parking lot entrance on the right. [39.991944, -75.199722](#)

**5K**

On MLK Jr Dr, 19' 1" after (north of) light pole D28 on the right; also 6' 6" before (south of) the south edge of storm drain W097 on the right. [39.993000, -75.198306](#)

**4M**

On MLK Jr Dr just before the railroad bridge overhead, 13' 2" before (south of) light pole F12 on the right; also 1' 5" past the southern edge of storm drain W131 on the right. [40.004778, -75.192806](#)

**TURNAROUND 1**

On MLK Jr Dr, even with the center of light pole F27 on the right; this pole is the 1st pole south of the yellow gate before Falls Br and has a "crosswalk ahead" sign. This turnaround point is in the center of the left lane of northbound traffic. [40.007278, -75.197222](#)

**5M**

On MLK Jr Dr, 9' 8" after (south of) the south edge of the 1st storm drain south of W128 storm drain on the right; this storm drain is near pole E22 on the far left. [39.999583, -75.193361](#)

**1M CHALLENGE START**

On MLK Jr Dr just after the Strawberry Mansion exit, even with the first unmarked metal light pole on the right; also 21' 4" after (south of) wooden pole 78009 on the right. [39.998194, -75.193972](#)

TURNAROUND 2

On Chamounix Dr, 42' 9" after (north of) wooden light pole 732 on the right (with 25MPH sign); also 9' 1" after "No Dumping" sign at tree on the right; also 198' 1" before (south of) wooden light pole 731 on the right. [40.001528, -75.198778](#)

6M

On Chamounix Dr, even with the stop sign at the Greenland Dr intersection on the left; stop sign is in line with tennis court #2 on the far right. [40.000167, -75.200056](#)

*1M CHALLENGE FINISH*

On Chamounix Dr between the two speed bumps, on the crosswalk to the tennis courts on the right, 3' 8" after (south of) pole 239E on the far right. [39.999000, -75.201389](#)

10K

On Chamounix Dr, 27' 2" before (north of) wooden light pole 62061 on the far left. [39.997972, -75.202972](#)

7M

At the end of the merge lane onto MLK Jr Dr from Strawberry Mansion Dr, 43' 8" after (south of) the south edge of storm drain W098 on the right; this storm drain just before the 25MPH light pole also on the right. [39.993972, -75.197472](#)

8M

On MLK Jr Dr, 123' 4" after (south of) the south edge of storm drain W055 on the left. [39.981694, -75.205944](#)

9M

On MLK Jr Dr, 27' 9" before (north of) light pole A-25 on the far left. [39.972278, -75.193222](#)

15K

On MLK Jr Dr, 15' 5" before (north of) light pole A-14 on the far left. [39.968306, -75.190444](#)

FINISH

In front of the Philadelphia Museum of Art, directly even with the center of the museum front entrance and steps; also directly even with the sidewalk crack running from the center of the middle of three metal grates on the sidewalk on the right. PK nail(s) along the curb on the right, as well as in the vehicle lane outside the protected bike lane. [39.964556, -75.179556](#)