



*Road Running Technical Council  
USA Track & Field*  
**Measurement Certificate**



Name of the course Tear Drop Half Marathon Distance 21.0975km  
Location (state) GA (city) Chatsworth  
Type of course: Road Race  
Measuring Methods: Bike  
Measured By Vince Adams (second rider) vinceadams30@gmail.com, 3044 Ridgeview Ct., Villa Rica, GA 30180  
Race Contact Sean Pfister (first rider) sean@iwelife.com, P.O Box 54001, Atlanta, GA 30308  
Date(s) when course measured: 09/03/2020  
Number of measurements of entire course: 2 Course Configuration: point to point  
Elevation (meters above sea level) Start 870m Finish 225m Lowest 225m Highest 870m  
Straight line distance between start and finish 9310m Drop 30.6 m/km Separation 44.13 %  
Type of surface: Paved 100 % Dirt 0 % Gravel 0 % Grass 0 % Track 0 %  
Effective date of certification: September 6, 2020 Certification code: GA20042WC

Note to Race Director: Use this Certification Code  
in all public announcements relating to your race.

## *Be It Officially Noted That*

Based on examination of data provided by the above named measurer, the course described above and in the map attached is hereby certified as reasonably accurate in measurement according to the standards adopted by the Road Running Technical Council. If any changes are made to the course, this certification becomes void, and the course must then be recertified.

**Verification of Course ---** In the event a National Open Record is set on the course, or at the discretion of USA Track & Field, a verification measurement may be required to be performed by a member of the Road Running Technical Council. If such a remeasurement shows the course to be short, then all pending records will be rejected and the course certification will be cancelled.

***This certification expires on December 31 of the year:*** **2030**

**AS NATIONALLY CERTIFIED BY:**

Date: September 9, 2020

Woody Cornwell - USATF/RRTC Certifier - 1532 Harrington St., Newberry SC 29108  
(803) 405-1525 - woody.cornwell@gmail.com

# TEAR DROP HALF MARATHON

(21.0975 km)

Chatsworth, GA



**Race Contact:** Sean Pfister, CEO  
 iWELife "Creating Events That Matter"  
 P.O. 54001, Atlanta, GA 30308  
 678-237-5434  
 sean@iwelife.com  
 www.iwelife.com

(34.7758380, -84.6668260)

**Half marathon Start (mile 0.0 & 3.6)**  
 (See Start Detail)  
 (No Scale)

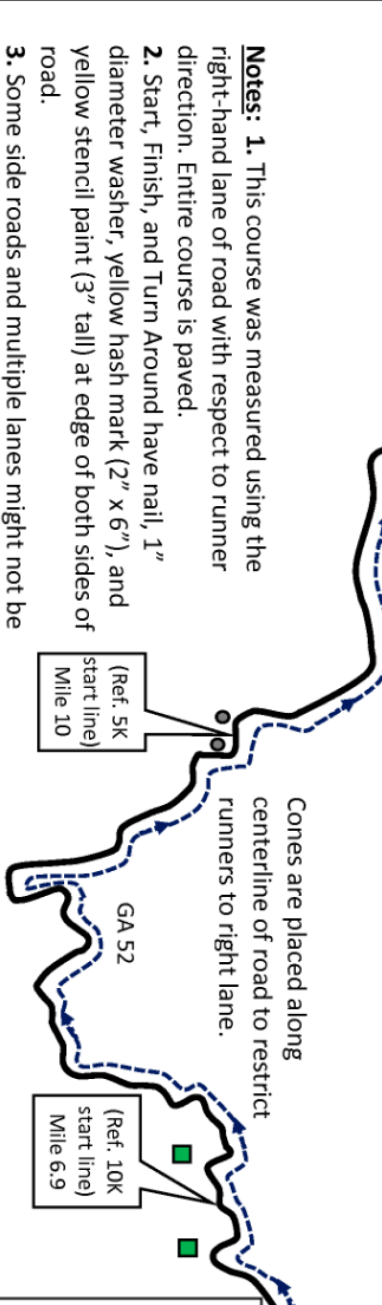
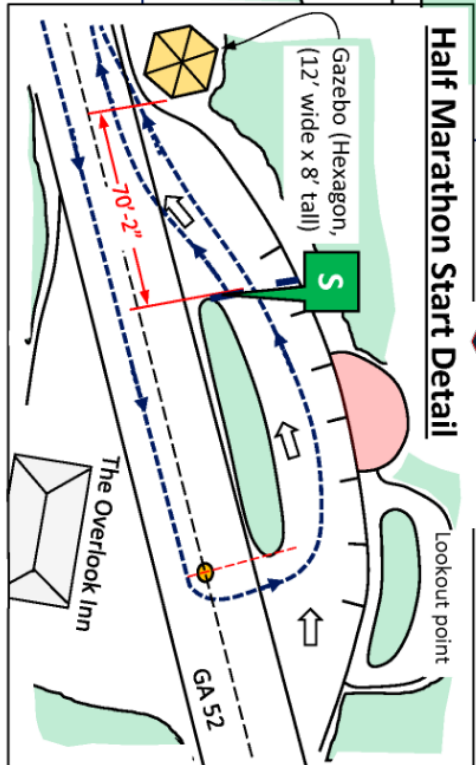
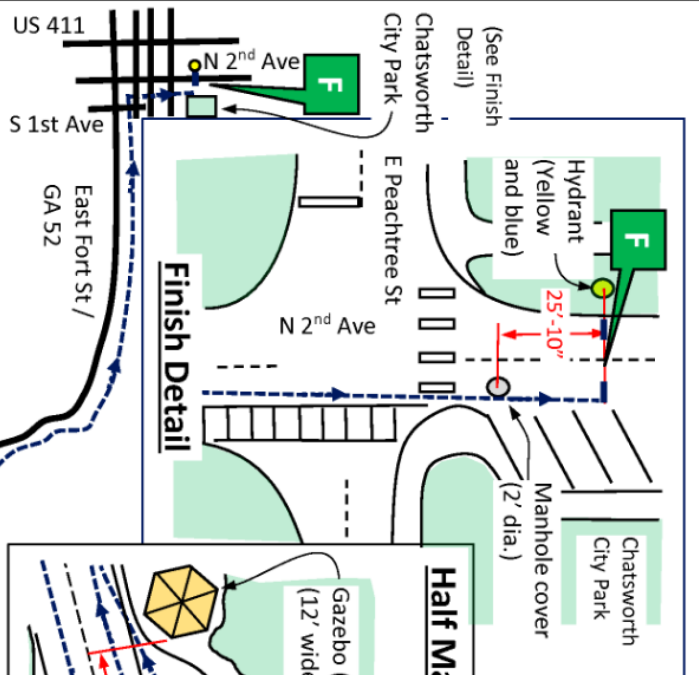

- Notes:**
1. This course was measured using the right-hand lane of road with respect to runner direction. Entire course is paved.
  2. Start, Finish, and Turn Around have nail, 1" diameter washer, yellow hash mark (2" x 6"), and yellow stencil paint (3" tall) at edge of both sides of road.
  3. Some side roads and multiple lanes might not be shown for clarity.
  4. See Sheet 2 for point descriptions with GPS coordinates. Enter coordinates in mapping tool for quick location of marks.

**Measurement and Drawing by:**  
 Vince Adams, P.E.  
 Villa Rica, GA  
 770-834-5032 vinceadams30@gmail.com  
 Sept. 3, 2020

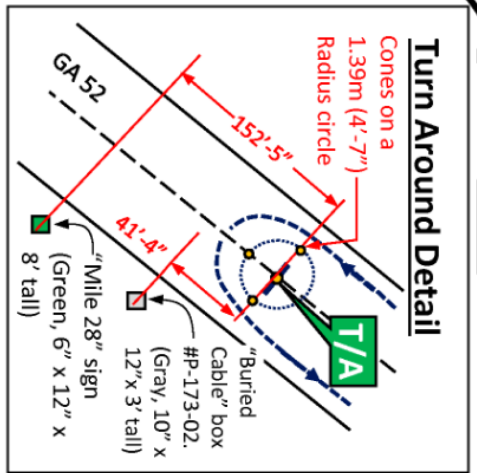

**Sheet 2**  
**Course description**

**TEAR DROP HALF MARATHON (21.0975 km)**  
**Chatsworth, GA**

<u>Point</u>	<u>Description</u>	<u>Reference GPS Coordinates</u>
Half Marathon (21.0975 km distance) Start	On GA Route 52. At the overlook across from The Overlook Inn at 9440 GA-52, Chatsworth, GA 30705. Aligned with the western apex on the long axis of island. 71'-2" E of the east edge of Gazebo.	34.7758380, -84.6668260
Turn Around (TA) for Half Marathon (Mile 1.8)	On GA Route 52. Around a 1.39m (4'-7") Radius circle on centerline of road at 152'-5" NE of Mile 28 sign (Green, 6" x 12" x 8' tall). 41'-4" NE of "Buried Cable" box #P-173-02" (Gray, 10" x 12" x 3' tall).	34.7627789, -84.6896486
Pass the half marathon start line again (Mile 3.6)	Same as Start above.	34.7758380, -84.6668260
<b>10K Race</b>		
Start line of 10K course (Mile 6.9 of half marathon)	On Georgia Route 52. GPS coordinates 34.7514001, -84.6993837. Marked with nail, washer and paint on both sides of road. There were no discernable landmarks (natural or manmade) for reference within 150 meters of point. (Ref. Between Hwy Mile marker #26 and #27. i.e. Uphill of Hwy Mile marker #26. Within a pull-out on northbound lane. North of a 2-car pullout on southbound lane.)	34.7514001, -84.6993837
<b>5K Race</b>		
Start line of 5K course (Mile 10 of half marathon. Mile 3.1 of the 10K course)	On Georgia Route 52. 88'-8" NW of Telephone pole no. 300 41. 130'-4" SE of Telephone pole no. 300 40 and "Buried Cable" box (Gray, 8" x 8" x 2' tall). (Ref. Between Hwy Mile marker #23 and #24. i.e. Uphill of Hwy Mile marker #23.)	34.7522596, -84.7288340
Finish for: half marathon 21.0975km (13.1 miles); 10K (6.2 miles); and 5K (3.1 miles)	On N 2nd Ave. Aligned with the first Hydrant that is on the west side of N 2nd Ave that is north of E Peachtree St. 25'-10" N of center of first manhole cover in the northbound lane of N 2nd Ave that is north of E Peachtree St.	34.7703120, -84.7686148